

**GENERAL NOTES  
(STORM DRAIN CONSTRUCTION)**

GENERAL NOTES (STORM DRAIN CONSTRUCTION)  
1. ALL WORKMANSHIP AND MATERIALS SHALL BE IN ACCORDANCE WITH THE CITY OF ALGONA STANDARDS AND THE MOST CURRENT COPY OF THE STATE OF WASHINGTON STANDARD SPECIFICATIONS FOR ROAD, BRIDGE AND MUNICIPAL CONSTRUCTION (WSDOT).

2. TEMPORARY EROSION/WATER POLLUTION MEASURES SHALL BE REQUIRED IN ACCORDANCE WITH CITY OF ALGONA STANDARDS

3. COMPLY WITH ALL OTHER PERMITS AND OTHER REQUIREMENTS BY THE CITY OF ALGONA OR OTHER GOVERNING AUTHORITY OR AGENCY AS MAY BE APPLICABLE.

4. A PRECONSTRUCTION MEETING SHALL BE HELD WITH THE CITY PRIOR TO THE START OF CONSTRUCTION.

5. ALL STORM MAINS AND RETENTION/DETENTION AREAS SHALL BE STAKED FOR GRADE AND ALIGNMENT BY AN ENGINEERING OR SURVEYING FIRM CAPABLE OF PERFORMING SUCH WORK, AND CURRENTLY LICENSED IN THE STATE OF WASHINGTON TO DO SO.

6. STORM DRAIN PIPE SHALL MEET THE FOLLOWING REQUIREMENTS:

A. PLAIN CONCRETE PIPE CONFORMING TO THE REQUIREMENTS OF AASHTO M 86, CLASS 2.

B. REINFORCED CONCRETE PIPE CONFORMING TO THE REQUIREMENTS OF AASHTO M 170.

C. PVC PIPE SHALL CONFORM TO ASTM D 3034-73 SDR 35 FOR 4" THRU 27" DIAMETER PVC PIPE, WITH JOINTS AND GASKETS CONFORMING TO ASTM D 3212 AND ASTM F 477.

D. DUCTILE IRON PIPE CONFORMING TO THE REQUIREMENTS OF ANSI A21.51, AND AWWA C 151, THICKNESS CLASS AS APPROVED BY CITY ENGINEER.

E. POLYETHYLENE SMOOTH WALL PIPE PER ADVANCED DRAINAGE SYSTEMS (ADS) N-12, BELL AND SPIGOT CONSTRUCTED PER WSDOT STANDARD SPECIFICATIONS 7-04. NOTE: THIS TYPE OF PIPE WILL ONLY BE BASED ON SITE SPECIFIC CONDITIONS AND IF ADDITIONAL ON-SITE INSPECTION TIME FOR WITNESSING PROPER PIPE INSTALLATION CAN BE SCHEDULED BY THE CITY.

7. SPECIAL STRUCTURES OIL/WATER SEPARATORS AND OUTLET CONTROLS SHALL BE INSTALLED PER PLANS AND MANUFACTURERS RECOMMENDATIONS.

8. PROVIDE TRAFFIC CONTROL PLAN(S) AS REQUIRED IN ACCORDANCE WITH MUTCD.

9. CALL UNDERGROUND LOCATE LINE 1-800-424-5555 MINIMUM 48 HOURS PRIOR TO ANY EXCAVATIONS.

10. WHERE CONNECTIONS REQUIRE "FIELD VERIFICATION", CONNECTION POINTS WILL BE EXPOSED BY CONTRACTOR AND FITTINGS VERIFIED 48 HOURS PRIOR TO DISTRIBUTING SHUTDOWN NOTICES.

11. STORM DRAIN PIPELINES SHALL BE INSTALLED TO THE FAR PROPERTY LINE(S) TO SERVE ADJACENT TRIBUTARY AREA AS MAY BE WARRANTED. THEY SHALL BE APPROPRIATELY SIZED TO ACCOMMODATE FLOWS AS FURTHER IDENTIFIED HEREIN. PIPES SHALL BE DESIGNED TO FACILITATE A MINIMUM 3 FEET/SECOND FLOW UNLESS OTHERWISE APPROVED BY THE CITY ENGINEER.

- ① YARD DRAIN No. 1  
RIM=77.35  
I.E.=74.85
- ② YARD DRAIN No. 2  
RIM=77.35  
I.E.=74.85
- ③ CB No.3 - TYPE II 54"  
W/ FRAME & GRATE  
GR.EL.= 77.48  
I.E.(W)= 71.90
- ④ CB No.4 - TYPE II 72"  
W/ FRAME & GRATE  
GR.EL.= 77.00  
I.E.(S,E)= 71.90  
I.E. (N)= 71.90
- ⑤ CB No.5 - TYPE II 60"  
CONTROL STRUCTURE  
W/ LOCKING LID  
SEE DTL. SHT. 3  
GR.EL.= 77.50  
I.E. (N&S)= 71.90  
I.E. (E)= 72.40
- ⑥ CB No.6 - TYPE II 54"  
W/ FRAME & GRATE  
GR.EL.= 77.00  
I.E.=74.53 (6"W)  
I.E.=73.44 (6"E)  
I.E.=71.90 (36")
- ⑦ CB No.7 - TYPE II 54"  
W/ FRAME & GRATE  
GR.EL.= 77.00  
I.E.= 74.53 (6"W)  
I.E.= 72.98 (6"E)  
I.E.= 71.90 (36")
- ⑧ CB No.8 - TYPE II 48"  
W/ SOLID LOCKING LID  
CONNECT TO EXISTING  
STORM PIPE  
GR.EL.= 77.25  
I.E.=71.86±
- ⑨ YARD DRAIN No. 9  
RIM=75.00±  
I.E.=73.36
- ⑩ YARD DRAIN No. 10  
RIM=75.00±  
I.E.=73.00
- ⑪ YARD DRAIN No. 11  
RIM=75.00±  
I.E.=73.50
- ⑫ YARD DRAIN No. 12  
RIM=75.00±  
I.E.=73.46
- ⑬ YARD DRAIN No. 13  
RIM=75.50±  
I.E.=74.00

- ① 6LF - 12" PVC SDR 35 @ 0.5%
- ② 47LF - 36" DETENTION TANK LEVEL @ 71.90
- ③ 83LF - 36" DETENTION TANK LEVEL @ 71.90
- ④ 27LF - 36" DETENTION TANK LEVEL @ 71.90
- ⑤ 87LF - 36" DETENTION TANK LEVEL @ 71.90
- ⑥ 7LF - 12" PVC SDR 35 @ 0.5%
- ⑦ 16LF - 6" PVC SDR 35 @ 2.0%
- ⑧ 16LF - 6" PVC SDR 35 @ 2.0%
- ⑨ 2LF - 6" PVC SDR 35 @ 1.0%
- ⑩ 36LF - 6" PVC SDR 35 @ 1.0%
- ⑪ 50LF - 6" PVC SDR 35 @ 1.0%
- ⑫ 2LF - 6" PVC SDR 35 @ 1.0%
- ⑬ 54LF - 6" PVC SDR 35 @ 1.0%

USE EXCAVATION FOR THE BIOSWALE AS TEMPORARY SEDIMENT TRAP PROVIDE 580 CF. MINIMUM SEDIMENT TRAP VOLUME ABOVE THE 1.5 FEET SEDIMENT DEPTH.

- ① TO BE REMOVED.
- ② MAILBOX TO BE RELOCATED PER P.O. DIRECTION.
- ③ ECOLOGY BLOCK OR EQUAL.
- ④ RESTORE YARD DRAIN IF DISTURBED DURING CONSTRUCTION.
- ⑤ INSTALL STABILIZED CONSTRUCTION ENTRANCE PER DETAIL ON SHEET 3.
- ⑥ SILT FENCE.
- ⑦ TYPE III BARRICADE.

25' PUBLIC UTILITY EASEMENT  
PER ORDINANCE NO 847  
REC. No. 9812020186

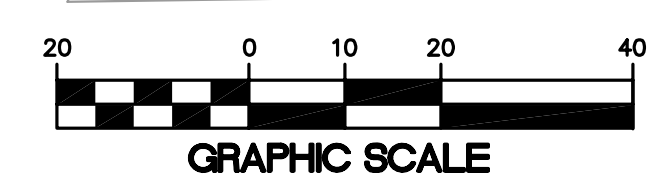
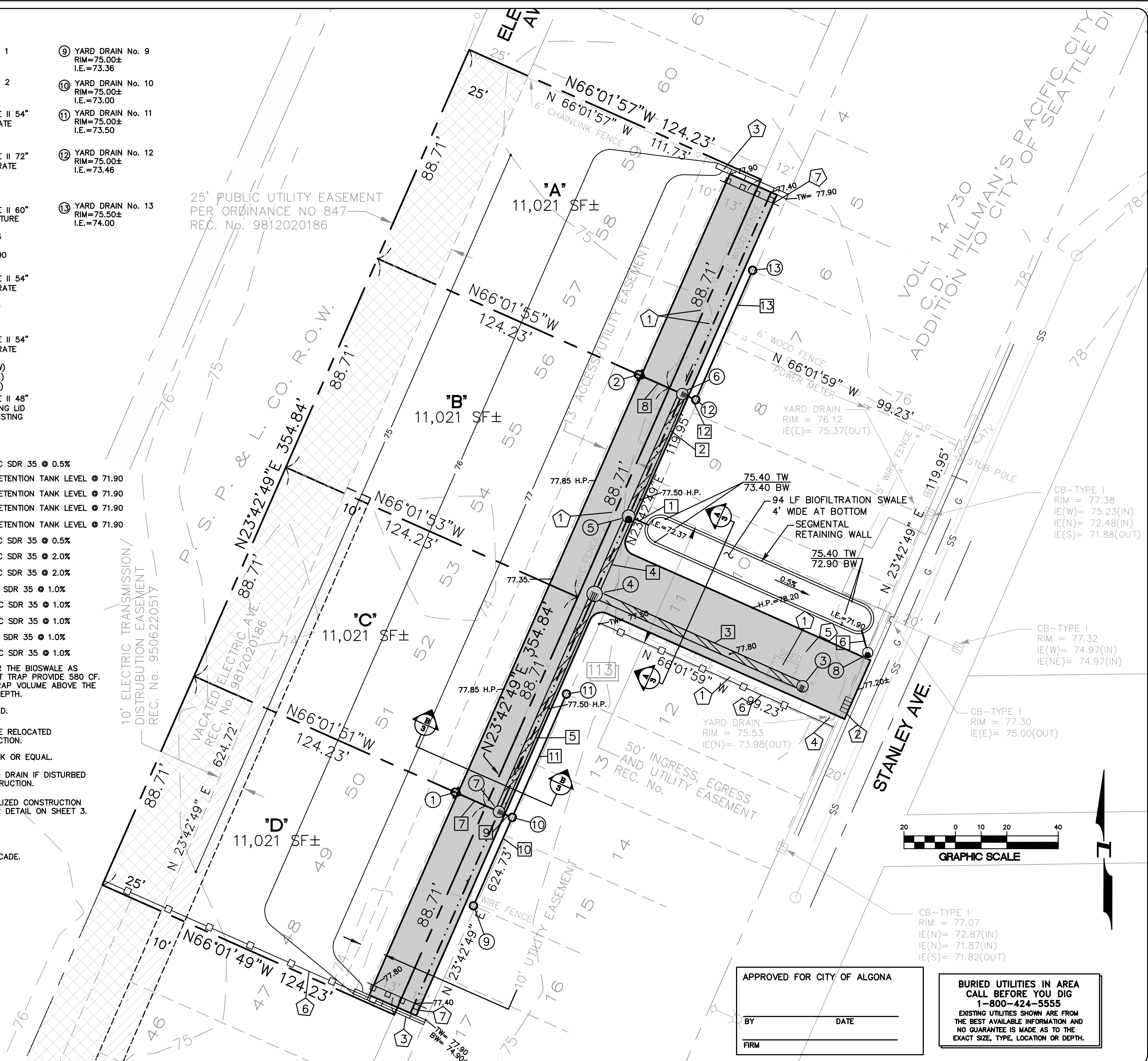

CB-TYPE I  
RIM = 77.07  
IE(N)= 72.87(IN)  
IE(N)= 71.87(IN)  
IE(S)= 71.82(OUT)

APPROVED FOR CITY OF ALGONA

BY \_\_\_\_\_ DATE \_\_\_\_\_

FIRM \_\_\_\_\_

**BURIED UTILITIES IN AREA  
CALL BEFORE YOU DIG**  
1-800-424-5555  
EXISTING UTILITIES SHOWN ARE FROM  
THE BEST AVAILABLE INFORMATION AND  
NO GUARANTEE IS MADE AS TO THE  
EXACT SIZE, TYPE, LOCATION OR DEPTH.

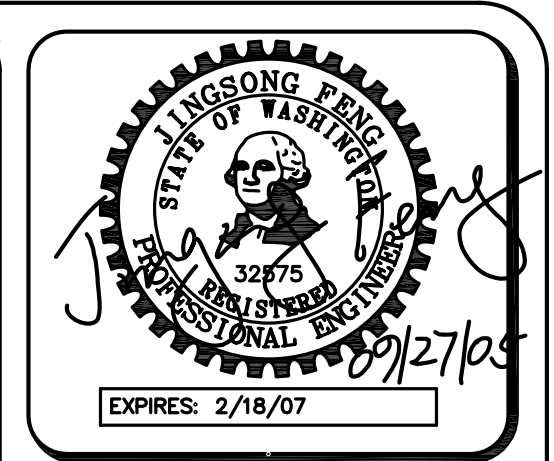

4180 LIND AVE S.W.  
RENTON, WA 98055  
PHONE: (425) 251-8811  
FAX: (425) 251-8880  
WEB SITE: PACENG.COM

**Engineering  
Design, LLC**

Civil Engineering and  
Planning Consultants

**FOOTHILLS SHORT PLAT**

FOR: SMART HOMES INC.  
107 WASHINGTON BLVD.  
ALGONA, WA 98001  
PHONE: (206) 510-4463, FAX: (206) 876-0680

PROJECT NO.: **05111**  
DRAWN BY: **GLD**  
ISSUE DATE: **09-27-05**  
SHEET REV.:

**TESC, GRADING AND  
DRAINAGE PLAN**

05111PED.DWG  
**C02**