

A PORTION OF SOUTHWEST 1/4 OF SOUTHWEST 1/4 SEC. 17, T. 20 N., R. 4 E., W.M.

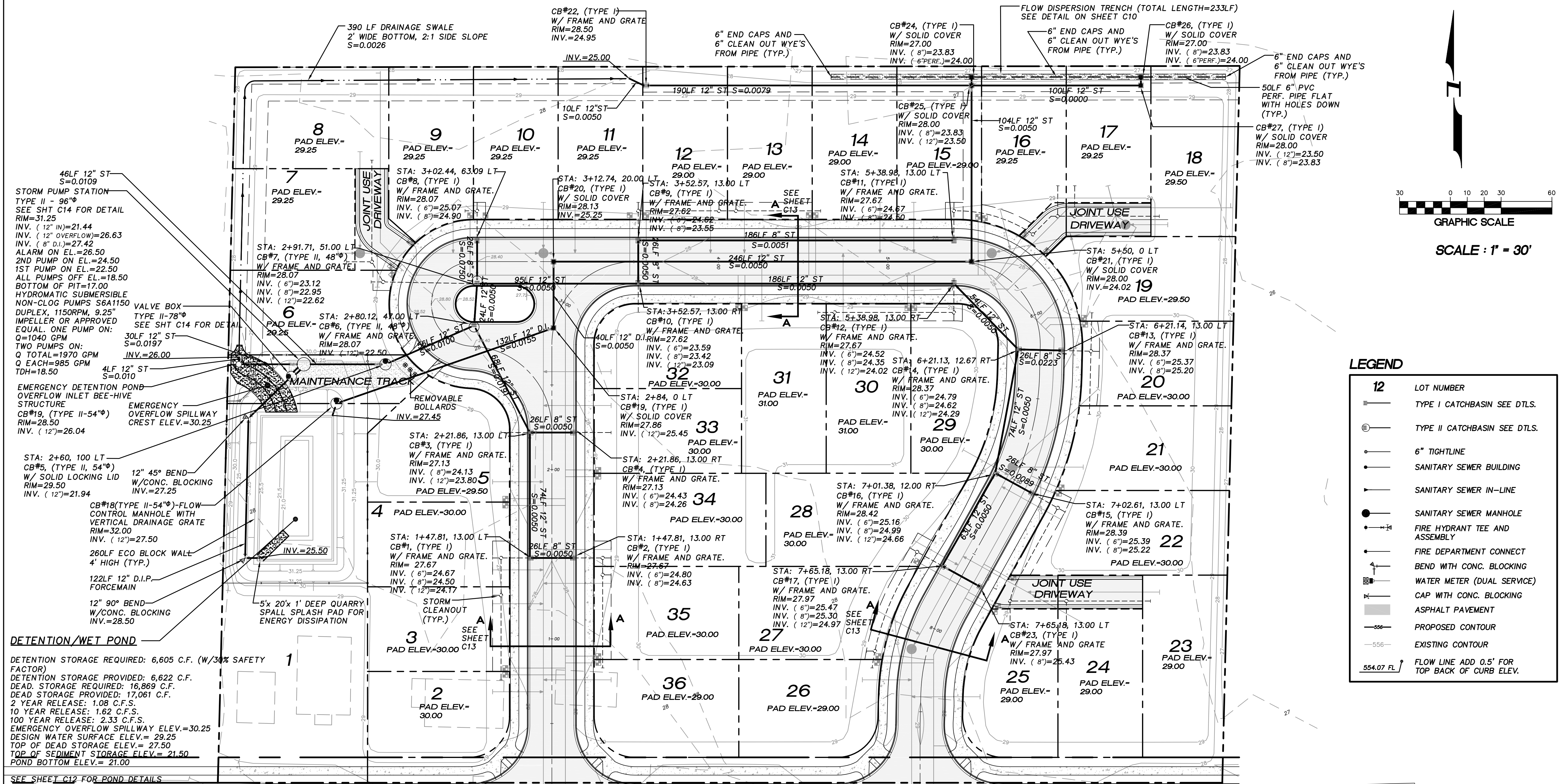

46LF 12" ST S=0.0109
STORM PUMP STATION
TYPE II - 96"
SEE SHT C14 FOR DETAIL
RIM=31.25
INV. (12" IN)=21.44
INV. (12" OVERFLOW)=26.63
INV. (8" D.I.)=27.42
ALARM ON EL.=26.50
2ND PUMP ON EL.=24.50
1ST PUMP ON EL.=22.50
ALL PUMPS OFF EL.=18.50
BOTTOM OF PIT=17.00
HYDROMATIC SUBMERSIBLE
NON-CLOG PUMPS S6A1150
DUPLX, 1150RPM, 9.25"
IMPELLER OR APPROVED
EQUAL ONE PUMP ON:
Q=1040 GPM
TWO PUMPS ON:
Q TOTAL=1970 GPM
Q EACH=985 GPM
TDH=18.50
4LF 12" ST S=0.010
EMERGENCY DETENTION POND
OVERFLOW INLET BEE-HIVE
STRUCTURE
CB#19, (TYPE II-54")
RIM=28.50
INV. (12")=26.04

STA: 2+60, 100 LT
CB#5, (TYPE II, 54")
W/ SOLID LOCKING LID
RIM=29.50
INV. (12")=21.94
12" 45° BEND
W/ CONC. BLOCKING
INV.=27.25
CB#18 (TYPE II-54")-FLOW
CONTROL MANHOLE WITH
VERTICAL DRAINAGE GRATE
RIM=32.00
INV. (12")=27.50
260LF ECO BLOCK WALL
4' HIGH (TYP.)
122LF 12" D.I.P.
FORCEMAIN
12" 90° BEND
W/ CONC. BLOCKING
INV.=28.50

DETENTION/WET POND
DETENTION STORAGE REQUIRED: 6,605 C.F. (W/30% SAFETY
FACTOR)
DETENTION STORAGE PROVIDED: 6,622 C.F.
DEAD STORAGE REQUIRED: 16,869 C.F.
DEAD STORAGE PROVIDED: 17,061 C.F.
2 YEAR RELEASE: 1.08 C.F.S.
10 YEAR RELEASE: 1.62 C.F.S.
100 YEAR RELEASE: 2.33 C.F.S.
EMERGENCY OVERFLOW SPILLWAY ELEV.=30.25
DESIGN WATER SURFACE ELEV.= 29.25
TOP OF DEAD STORAGE ELEV.= 27.50
TOP OF SEDIMENT STORAGE ELEV.= 21.50
POND BOTTOM ELEV.= 21.00
SEE SHEET C12 FOR POND DETAILS

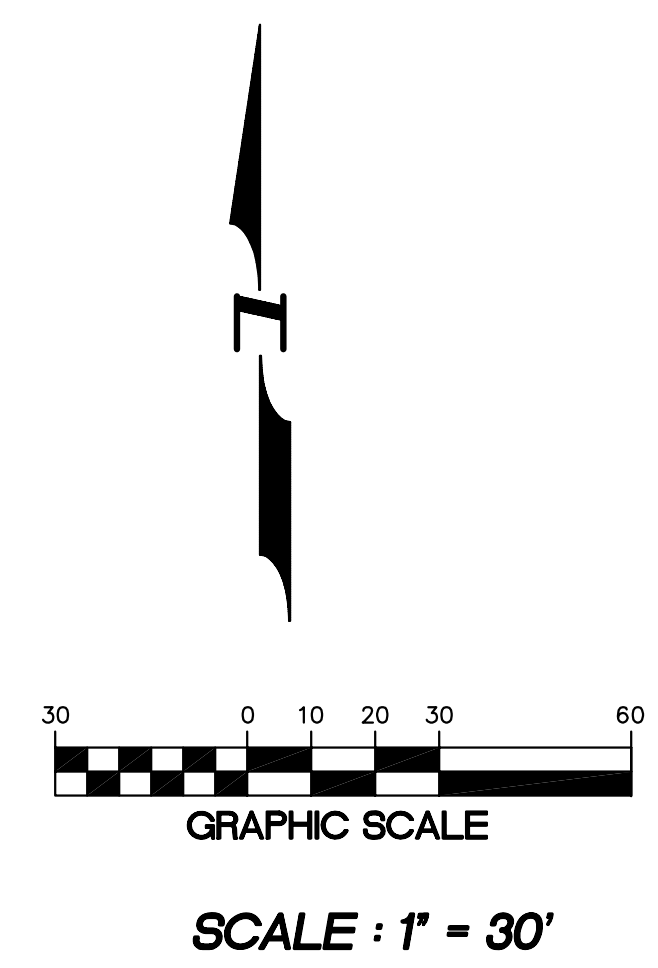

LEGEND

12	LOT NUMBER
—	TYPE I CATCHBASIN SEE DTLS.
⊕	TYPE II CATCHBASIN SEE DTLS.
—	6" TIGHTLINE
—	SANITARY SEWER BUILDING
—	SANITARY SEWER IN-LINE
●	SANITARY SEWER MANHOLE
—	FIRE HYDRANT TEE AND ASSEMBLY
—	FIRE DEPARTMENT CONNECT
—	BEND WITH CONC. BLOCKING
—	WATER METER (DUAL SERVICE)
—	CAP WITH CONC. BLOCKING
—	ASPHALT PAVEMENT
—	PROPOSED CONTOUR
—	EXISTING CONTOUR
554.07	FLOW LINE ADD 0.5' FOR TOP BACK OF CURB ELEV.



15445 53RD AVE. S
SEATTLE, WA 98188
PHONE: (206) 431-7970
FAX: (206) 388-1648
WEB SITE: PACENG.COM

Pacific Engineering Design, LLC
Civil Engineering and Planning Consultants

FOXBORO PLAT
FOR MARTY AND CHARLOTTE POTTER
FILED IN THE EAST DISTRICT
FILE NO. WA 98424
PHONE (206) 926-5481

PROJECT NO.: **04090**
DRAWN BY: **VK**
ISSUE DATE: **10-11-06**
SHEET REV.:

GRADING AND DRAINAGE PLAN

04090R01-05.DWG
P05