

PORTION OF THE SW 1/4, SECTION 32, T. 21 N., R. 5 E., W.M.

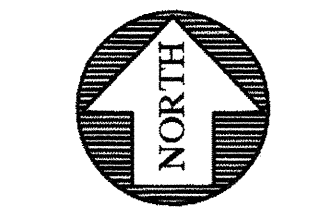

SCALE 1" = 40'

KEYMAP

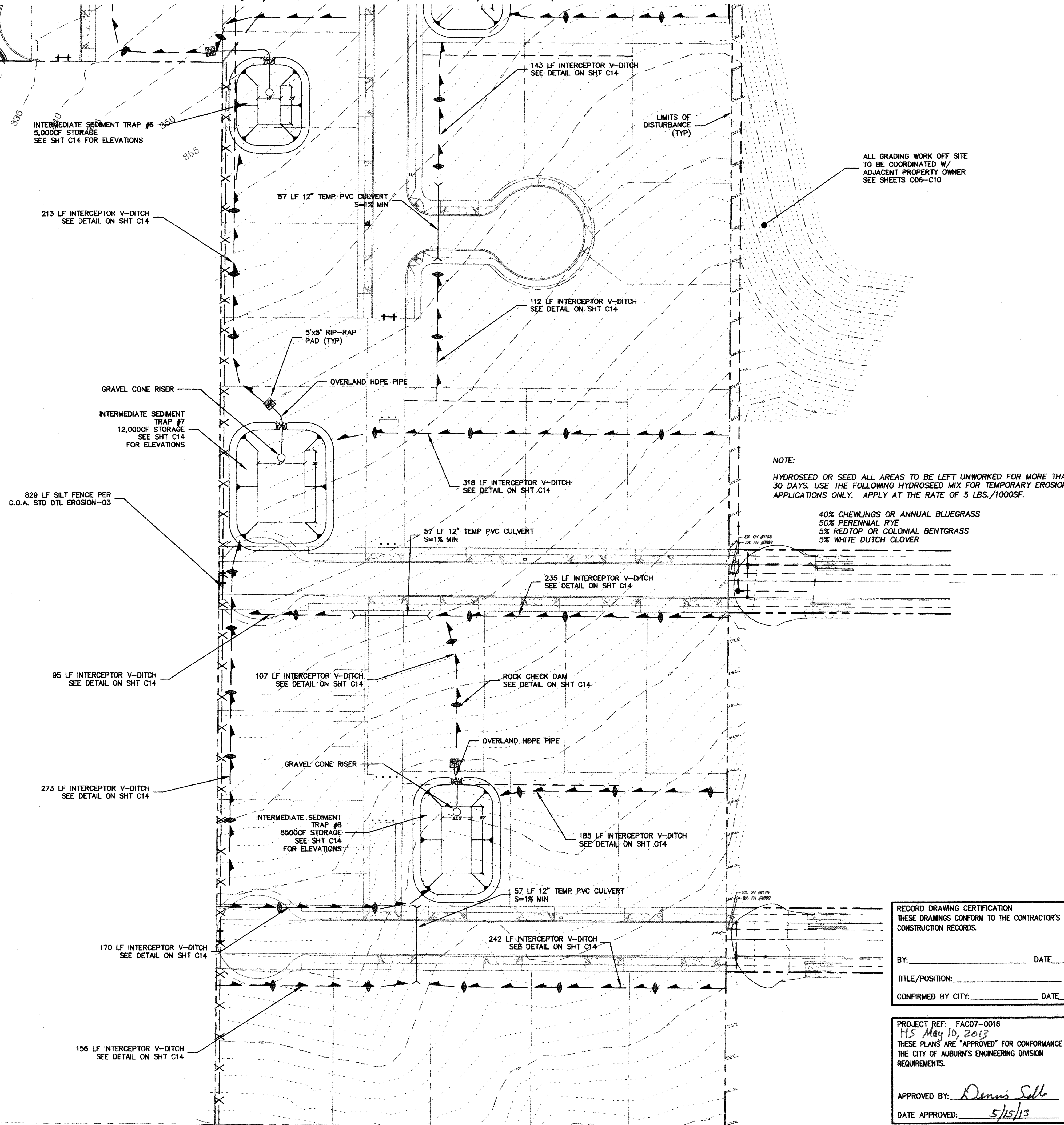
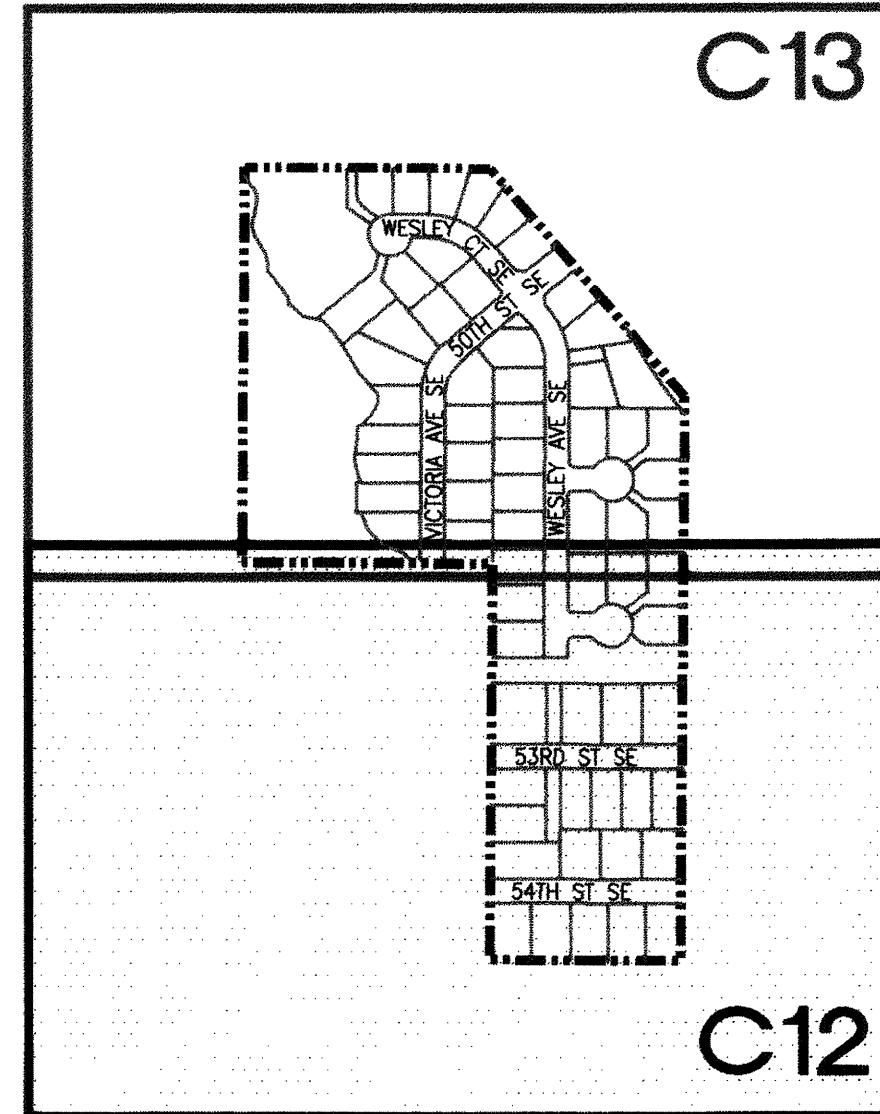

NOTE:
HYDROSEED OR SEED ALL AREAS TO BE LEFT UNWORKED FOR MORE THAN 30 DAYS. USE THE FOLLOWING HYDROSEED MIX FOR TEMPORARY EROSION APPLICATIONS ONLY. APPLY AT THE RATE OF 5 LBS./1000SF.

- 40% CHEWLINGS OR ANNUAL BLUEGRASS
- 50% PERENNIAL RYE
- 3% REDTOP OR COLONIAL BENTGRASS
- 3% WHITE DUTCH CLOVER

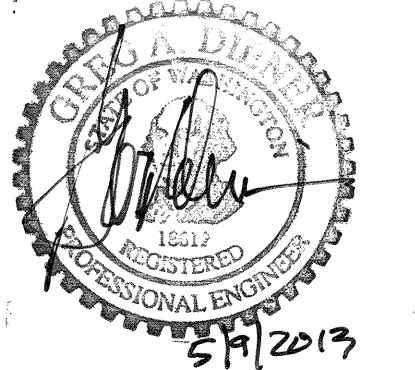

15445 53RD AVE. S.
SEATTLE, WA 98188
PHONE: (206) 431-7970
FAX: (206) 388-1648
WEB SITE: PACENG.COM

Pacific Engineering Design, LLC
Civil Engineering and Planning Consultants

LAKELAND HILLS ESTATES
CITY OF AUBURN

FOR:
DENOVA NORTH-WEST, LLC.
C/O MILLER BUILDERS
12800 MILLER PARK RD. #100
AUBURN, WA 98002
PHONE: (206) 425-3864
FAX: (206) 299-9519

PROJECT NO.: 12022
DRAWN BY: ENM
ISSUE DATE: 07-17-07
SHEET REV.: 3-20-2013

TEMPORARY EROSION AND SEDIMENT CONTROL PLAN

RECORD DRAWING CERTIFICATION
THESE DRAWINGS CONFORM TO THE CONTRACTOR'S CONSTRUCTION RECORDS.

BY: _____ DATE _____
TITLE/POSITION: _____
CONFIRMED BY CITY: _____ DATE _____

PROJECT REF: FAC07-0016
HS May 10, 2013
THESE PLANS ARE "APPROVED" FOR CONFORMANCE WITH THE CITY OF AUBURN'S ENGINEERING DIVISION REQUIREMENTS.

APPROVED BY: *Dennis Sells*
DATE APPROVED: 5/15/13

05056TE01-C05.DWG
C12
SHEET 12 OF 55