

N.W. 1/4, SEC. 26, T. 21 N., R. 4 E., W.M.

**LAKEHAVEN UTILITY DISTRICT**

0 Water Plan      8 Sewer Plan

Dated \_\_\_\_\_

**APPROVED FOR CONSTRUCTION**  
SUBJECT TO CHANGES NOTED

The District's review is not a check of any dimension or quantities and will not relieve the Developer from responsibility for errors of any sort. No changes shall be made in the plans except by the consent of the District.

---

General Manager/District Engineer      Date \_\_\_\_\_

This construction plan will expire one year from plan approval date, if construction has not commenced.

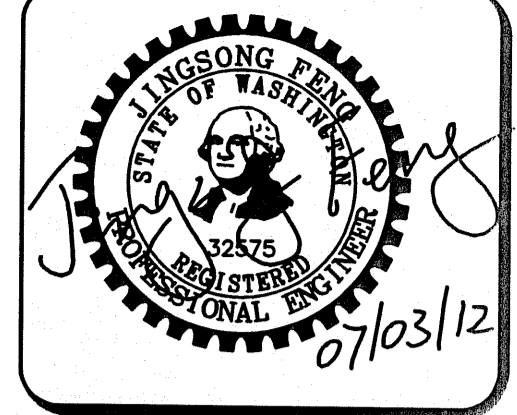

15445 53RD AVE. S.  
SEATTLE, WA 98188  
PHONE: (206) 431-7970  
FAX: (206) 388-1648  
WEB SITE: PACENG.COM

**Pacific  
Engineering  
Design, LLC**

Civil Engineering and  
Planning Consultants

**VERTICAL DATUM :**

NAVD 88

**BENCH MARK :**

KING COUNTY SURVEY CONTROL POINT No. 6905,  
SW CORNER OF SECTION 27, T 24 N, R 4 E, W.M.,  
CONCRETE MONUMENT WITH LEAD AND BRASS TACK,  
SET 1.2 FEET BELOW GRADE, IN STANDARD KC MON. CASE.  
ELEVATION = 367.06

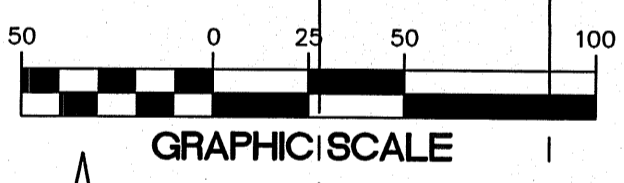
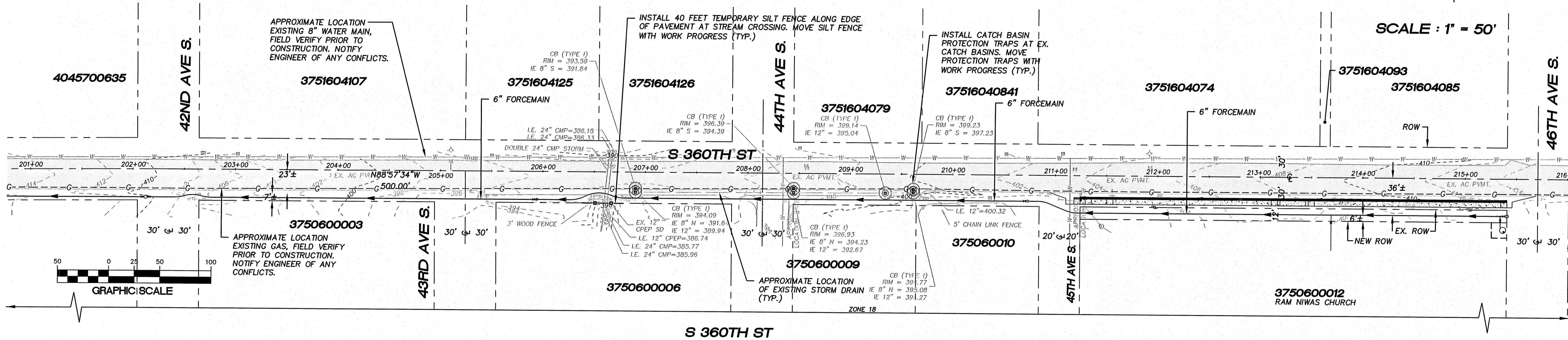
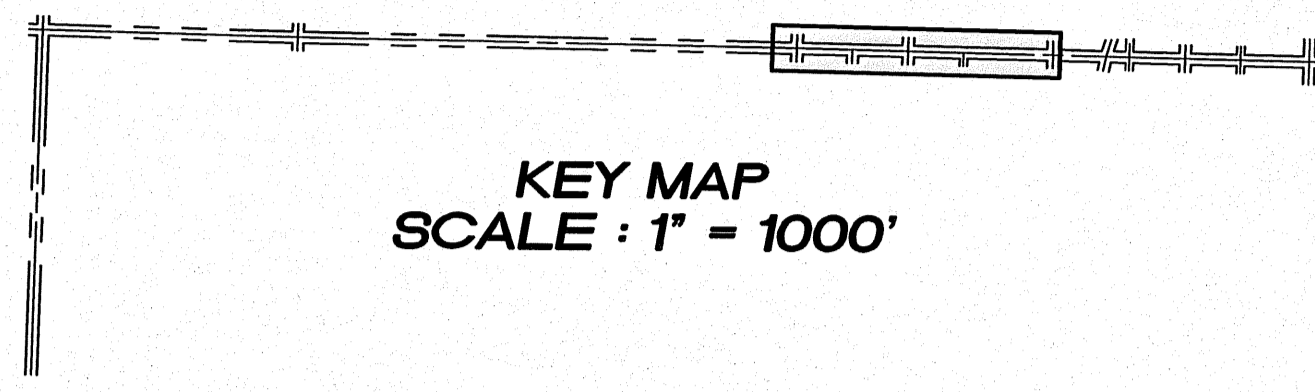

**LEGEND**

- CB PROTECTION
- SILT FENCE
- HIGH VISIBILITY FENCE
- TEMP CONSTRUCTION ENTRANCE

NOTE:  
CLEAN UP STREET EVERY DAY WITH SWEEPER  
AND HAUL OUT EXCESS DIRT.

LAKEHAVEN UTILITY DISTRICT PROJECT No. 6308021  
**RAM NIWAS CHURCH**  
KING COUNTY, WA.

FOR:  
SARKAR HOLDINGS, LLC  
27902 36TH AVENUE SOUTH  
AUBURN, WA 98001

PROJECT NO.: 10021  
DRAWN BY: JGC  
ISSUE DATE: 8-31-2011  
SHEET REV.: 07-03-2012

**TEMPORARY  
EROSION CONTROL  
PLAN**

05052SS.DWG  
**SS10**