

N.W. 1/4, SEC. 26, T. 21 N., R. 4 E., W.M.

- 5 ISOLATION VALVE W/TRACER WIRE STATION SEE SHEET SS03
- 5A 1-1/2" WASTEWATER AIR RELEASE VALVE SEE SHEET SS08 FOR DETAIL
- 6 2-6" ISOLATION GATE VALVE W/BOX
1-6" FORCE MAIN CLEANOUT W/PIG PORT #1
1-6" HDPE DR 11 SPOOL, SEE SHEET SS08 FOR DETAIL
- 7 1-6" ISOLATION GATE VALVE W/BOX
- 1 REPLACE EX. 12" A.C. WATER, INSTALL 8 LF 12" D.I. CL50 WATER 2 FEET INTO TRENCH WALLS.

VERTICAL DATUM :
NAVD 88

BENCH MARK :
KING COUNTY SURVEY CONTROL POINT No. 6905,
SW CORNER OF SECTION 27, T 24 N., R 4 E., W.M.,
CONCRETE MONUMENT WITH LEAD AND BRASS TACK,
SET 1.2 FEET BELOW GRADE, IN STANDARD KC MON. CASE.
ELEVATION = 367.06

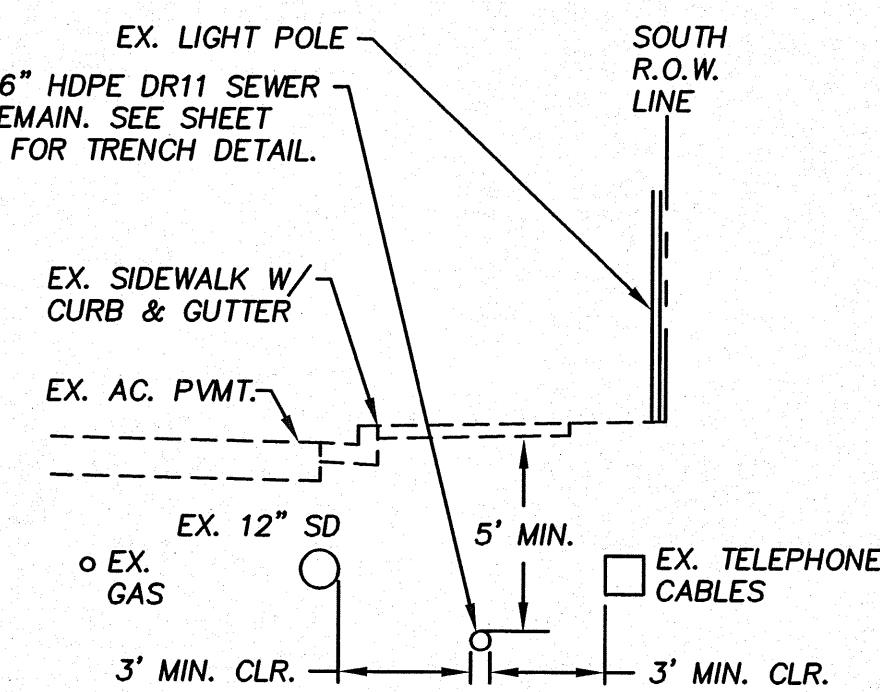
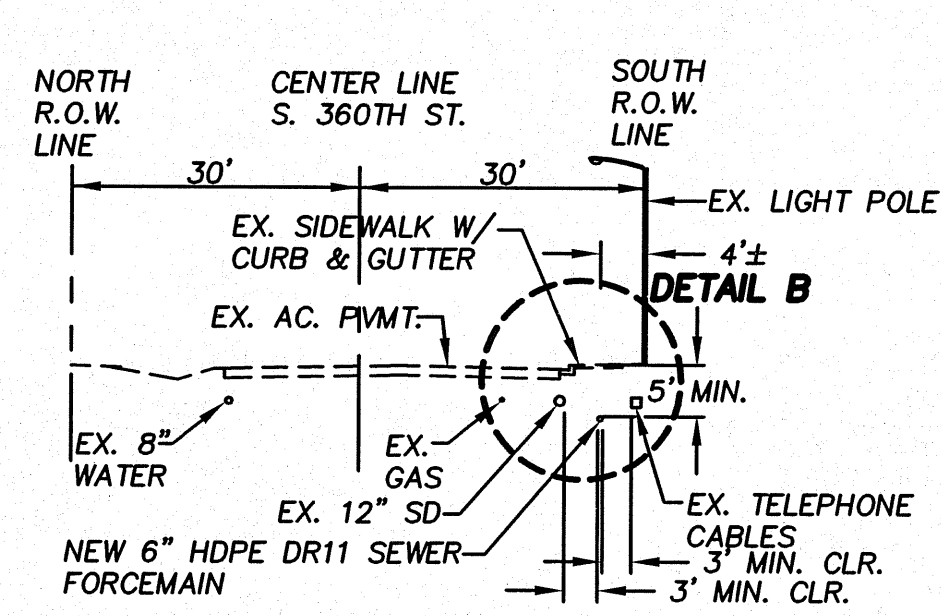
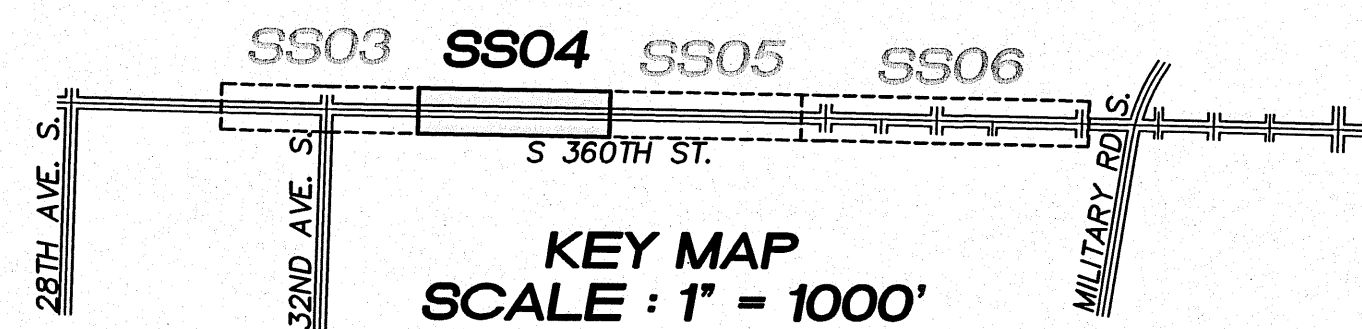

LAKEHAVEN UTILITY DISTRICT

0 Water Plan 0 Sewer Plan

Date: _____

APPROVED FOR CONSTRUCTION
SUBJECT TO CHANGES NOTED

The District's review is not a check of any dimension or quantities and will not relieve the Developer from responsibility for errors of any sort. No changes shall be made in the plans except by the consent of the District.

General Manager/District Engineer Date

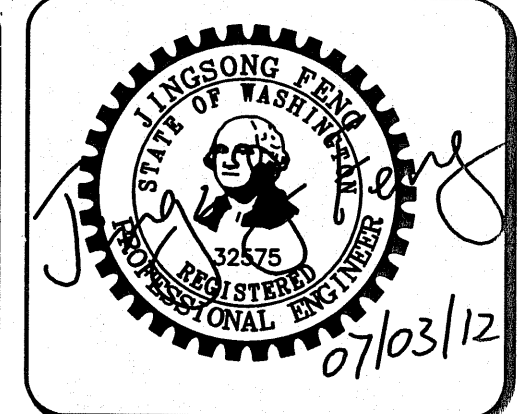

15445 53RD AVE. S.
SEATTLE, WA 98188
PHONE: (206) 431-7970
FAX: (206) 388-1648
WEB SITE: PACENG.COM

Pacific Engineering Design, LLC
Civil Engineering and Planning Consultants

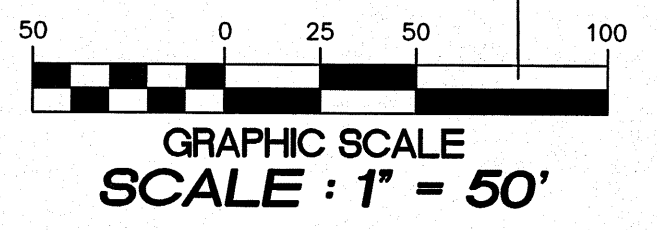
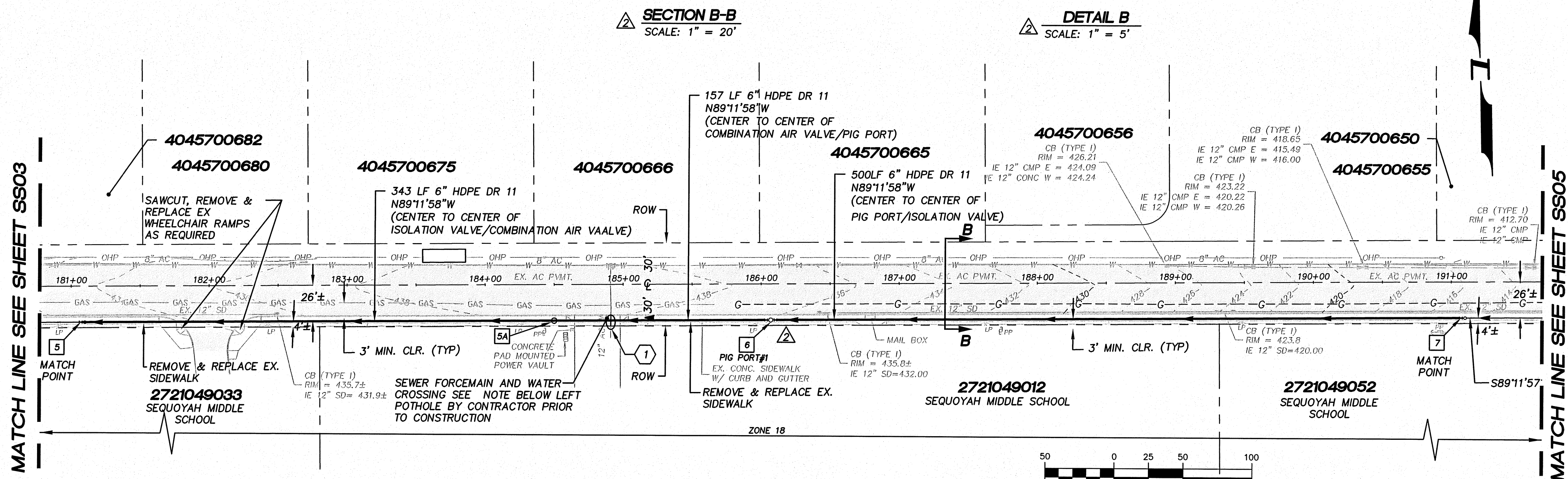

- NOTES :**
- THE MINIMUM SEPARATION BETWEEN (PARALLEL PIPELINES) WATER MAIN, WATER SERVICE LINE AND PRESSURE SEWER FACILITIES (MUST BE BELOW WATER MAIN OR WATER SERVICE) MUST BE MET, ARE AS FOLLOWS: HORIZONTAL >=10' MEASURED EDGE TO EDGE VERTICAL >=18" MEASURED EDGE TO EDGE.
 - THE MINIMUM SEPARATION BETWEEN (CROSSING PIPELINES) WATER MAIN, WATER SERVICE LINE AND PRESSURE SEWER FACILITIES (MUST BE BELOW WATER MAIN OR WATER SERVICE) MUST BE MET, ARE AS FOLLOWS: HORIZONTAL >=18" MEASURED EDGE TO EDGE.
 - IF THE EXISTING WATER IS AC PIPE, IT SHALL BE REPLACED WITH SAME SIZE DUCTILE IRON PIPE NO LESS THAN 2 FEET INTO BOTH TRENCH WALLS (NO CDF CRADLE ALLOWED).
 - LOCATION OF EXISTING UNDERGROUND UTILITIES WAS PROVIDED BY UTILITY LOCATE AND BY AS BUILT RECORDS. UTILITY PAINT MARKS WERE FIELD SURVEYED BY CES NW INC.
 - OTHER UTILITY SEPARATION BETWEEN PRESSURE SEWER FACILITIES MUST BE MET, ARE AS FOLLOWS: HORIZONTAL >=3' MEASURED EDGE TO EDGE VERTICAL >=6" MEASURED EDGE TO EDGE.
 - FOR PARCELS IN PEPPER HILL ESTATES AREAS, EXISTING PARCEL NUMBERS AND LOT NUMBERS WILL BE UPDATED AFTER BOUNDARY LINE ADJUSTMENTS ARE RECORDED.
 - ALL CLEANOUTS W/PIG PORTS ARE USED AS TRACE WIRE STATIONS.
 - FRAMES AND COVERS FOR CLEANOUTS/PIGPORTS NOT SUBJECT TO VEHICULAR TRAFFIC SHALL BE SET 6" ABOVE FINISHED GRADE AND BE PROTECTED BY VALVE BOX PROTECTIVE PADS.
 - TRACER WIRES ARE REQUIRED FOR THE 6" LPS LINES. THE WIRES SHOULD BE TAGGED OR LABELED IN EACH TRACER WIRE STATION. TAGS SHOULD BE STAINLESS OR OTHER NON RUSTING METAL.

REMOVE & REPLACE EX. SIDEWALK ALONG THE FRONTAGE OF SEQUOYAH MIDDLE SCHOOL. VERIFY LOCATIONS OF UTILITIES NEAR AND UNDER THE SIDEWALK PRIOR TO CONSTRUCTION. NOTIFY ENGINEER OF ANY CONFLICTS.

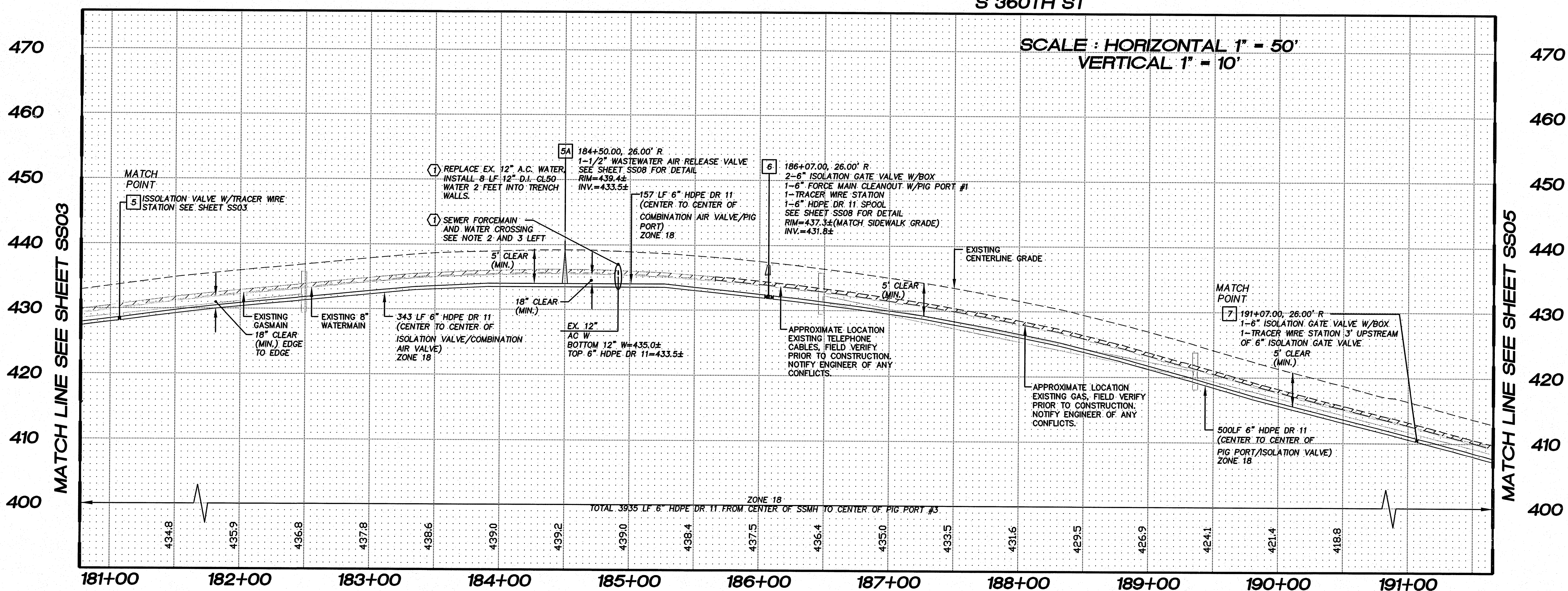

LAKEHAVEN UTILITY DISTRICT PROJECT No. 6308021
RAM NIWAS CHURCH
KING COUNTY, WA.

FOR: SARKAR HOLDINGS, L.L.C.
27902 36TH AVENUE SOUTH
AUBURN, WA 98001

PROJECT NO.: 10021
DRAWN BY: JGC
ISSUE DATE: 7-23-2010
SHEET REV.: 07-03-2012

**FORCE MAIN
SANITARY SEWER
S 360TH ST
STA. 181+07.00 TO
STA. 191+07.00
PLAN AND PROFILE**

050525S02-SS02-SS06.DWG
SS04