

N.W. 1/4, SEC. 26, T. 21 N., R. 4 E., W.M.

VERTICAL DATUM :

NAD 88

BENCH MARK :

KING COUNTY SURVEY CONTROL POINT No. 6905
 SW CORNER OF SECTION 27, T. 24 N., R. 4 E. W.M.,
 SONGE T. MONUMENT WITH LEAD AND BRASS TACK,
 SET 1.2 FEET BELOW GRADE, IN STANDARD RO. MON. CASE.
 ELEVATION = 367.06

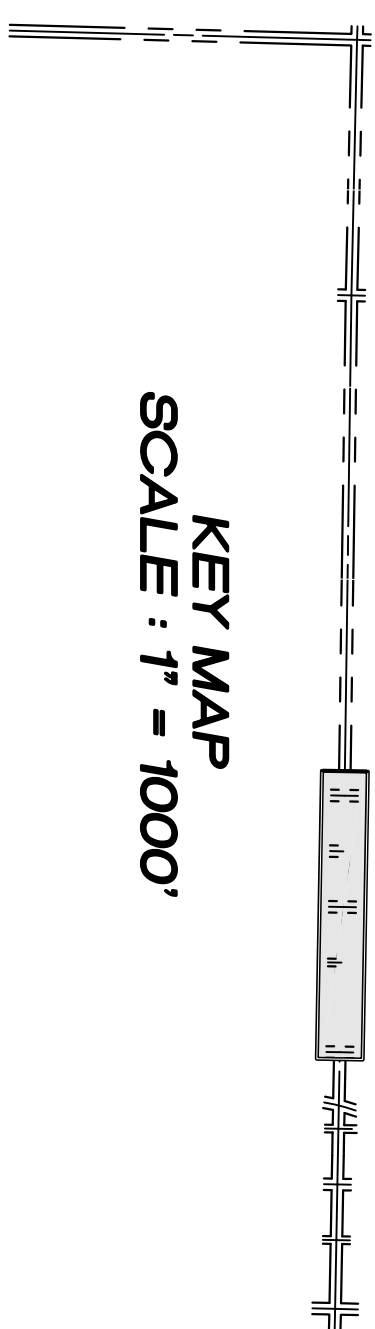

| | |
|--|--------------|
| LAKEHAVEN UTILITY DISTRICT | |
| 0 Water Plan | 9 Sewer Plan |
| Dated _____ | |
| APPROVED FOR CONSTRUCTION | |
| SUBJECT TO CHANGES VOTED | |
| <p>The District's review is not a check of any dimension or quantities and will not relieve the Developer from responsibility for errors of any sort. No changes shall be made in the plans except by the consent of the District.</p> | |
| General Manager/District Engineer | Date |
| <p>This construction plan will expire one year from plan approval date, if construction has not commenced.</p> | |

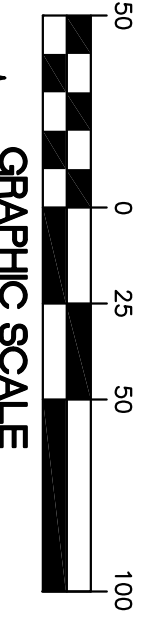
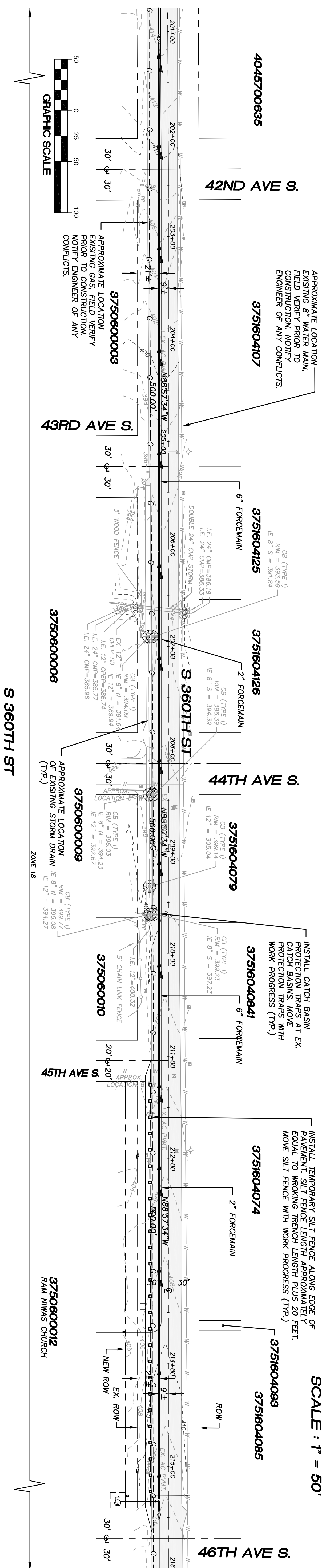

LEGEND

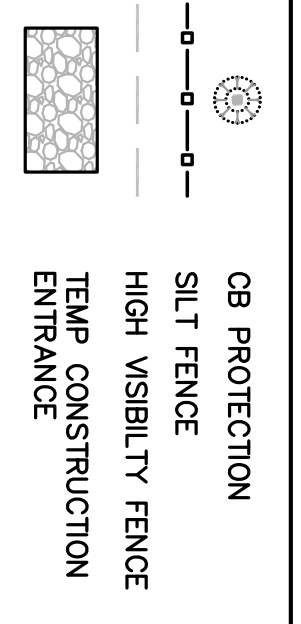

LAKEHAVEN UTILITY DISTRICT PROJECT No. 6308021
RAM NIWAS CHURCH
 KING COUNTY, WA.

FOR:
 SATGURU RAM SINGH STANG
 15701 138TH PLACE SE
 RENTON, WA 98058
 PHONE: (206) 304-1911

Pacific Engineering Design, LLC
 Civil Engineering and Planning Consultants

15445 53RD AVE. S.,
 SEATTLE, WA 98188
 PHONE: (206) 431-7970
 FAX: (206) 388-1648
 WEB SITE: PACENG.COM

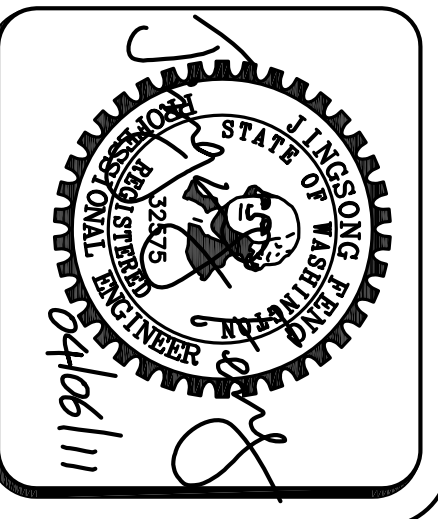

PROJECT NO.: 10021
 DRAWN BY: JQC
 ISSUE DATE: 7-23-2010
 SHEET REV:

TEMPORARY EROSION CONTROL PLAN

