

- 9 2-6" ISOLATION GATE VALVE W/BOX
1-6" FORCE MAIN CLEANOUT W/PIG PORT #3
1-6" HDPE DR 11 SPOOL
- 10 1-6" ISOLATION GATE VALVE W/BOX
- 11 1-6" ISOLATION GATE VALVE W/BOX
- 11B 1-6"x4" HDPE DR 11 W/VE
1-4" HDPE DR 11 45° BEND
- 12 2-6" ISOLATION GATE VALVE W/BOX
1-6" FORCE MAIN CLEANOUT W/PIG PORT #4
1-6" HDPE DR 11 SPOOL

VERTICAL DATUM:

NAVD 88
BENCH MARK:
KING COUNTY SURVEY CONTROL POINT No. 8905
SW CORNER OF SECTION 27, T. 24 N., R. 4 E., W.M.,
CHANGE ELEVATION WITH LEAD AND BRASS TACK,
SET 1/2 FEET BELOW GRADE, IN STANDARD RO MON. CASE.
ELEVATION = 367.06

N.W. 1/4, SEC. 26, T. 21 N., R. 4 E., W.M.

SS03 SS04 SS05 SS06

KEY MAP
SCALE: 1" = 1000'

LAKEHAVEN UTILITY DISTRICT	Date
0 Water Plan	9 Sewer Plan
APPROVED FOR CONSTRUCTION SUBJECT TO CHANGES VOTED	
The District's review is not a check of any dimension or quantity and will not relieve the Developer from responsibility for errors of any sort. No changes shall be made in the plan except by the consent of the District.	
General Manager/District Engineer	Date

SCALE: 1" = 50'

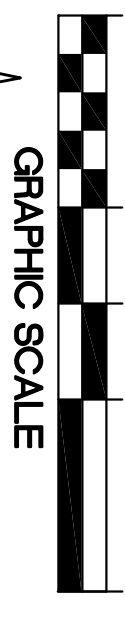
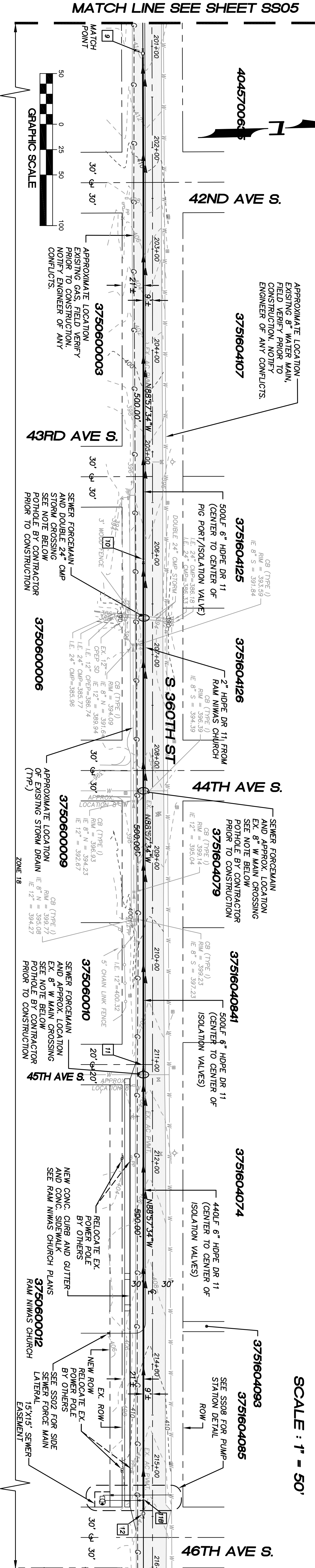

S 3607TH ST

SCALES: HORIZONTAL 1" = 50'
VERTICAL 1" = 10'

- NOTES:**
1. THE MINIMUM SEPARATION BETWEEN (PARALLEL) PIPELINES) WATER MAIN, WATER SERVICE LINE AND PRESSURE SEWER FACILITIES (MUST BE BELOW WATER MAIN OR WATER SERVICE) MUST BE MET.
 2. ARE AS FOLLOWS: HORIZONTAL >= 10' (MEASURED EDGE TO EDGE VERTICAL >= 6" MEASURED EDGE TO EDGE.
 3. ARE AS FOLLOWS: HORIZONTAL >= 18" (MEASURED EDGE TO EDGE VERTICAL >= 6" MEASURED EDGE TO EDGE.
 4. IF THE EXISTING WATER IS AC PIPE, IT SHALL BE REPLACED WITH SAME SIZE DUCTILE IRON PIPE 10 FEET EACH SIDE OF SEWER CROSSING BUT NO LESS THAN 2 FEET INTO BOTH TRENCH WALLS (NO LOCATIONS ALLOWED).
 5. UNDERGROUND UTILITIES WAS PROVIDED BY UTILITY LOCATE AND BY AS BUILT RECORDS. UTILITY PAINT MARKS WERE FIELD SURVEYED BY GCS NW INC.
 6. OTHER UTILITY SEPARATION BETWEEN PRESSURE SEWER FACILITIES MUST BE MET ARE AS FOLLOWS: HORIZONTAL >= 3' MEASURED EDGE TO EDGE VERTICAL >= 6" MEASURED EDGE TO EDGE.
 7. FOR PARCELS IN PEPPER HILL ESTATES AREAS EXISTING PACE NUMBERS AND LOT NUMBERS WILL BE UPDATED AFTER BOUNDARY LINE ADJUSTMENTS ARE RECORDED.
 8. ALL CLEANOUTS W/PIG PORTS ARE USED AS TRACE WIRE STATIONS.
 9. FRAMES AND COVERS FOR CLEANOUTS/PIGPORTS NOT SUBJECT TO VEHICULAR TRAFFIC SHALL BE SET 6" ABOVE FINISHED GRADE AND BE PROTECTED BY VALVE BOX PROTECTIVE PADS.
 10. INSTALL APPROXIMATELY 4300 LBS. OF 2" HDPE DR11 FORCEMAIN AT THE SAME TRENCH OF THE 6" HDPE DR11 FORCEMAIN FROM SSM #10 (S-1727) TO THE RAM NIWAS CHURCH. HORIZONTAL SEPARATION BETWEEN 2" AND 6" FORCEMAINS SHOULD BE 2'. AND AS CONSISTENT AS POSSIBLE. PIPE CROWN ELEVATIONS SHOULD MATCH. TRACER WIRE AND TRACER WIRE STATIONS ONLY APPLY TO THE 6" FORCEMAIN.

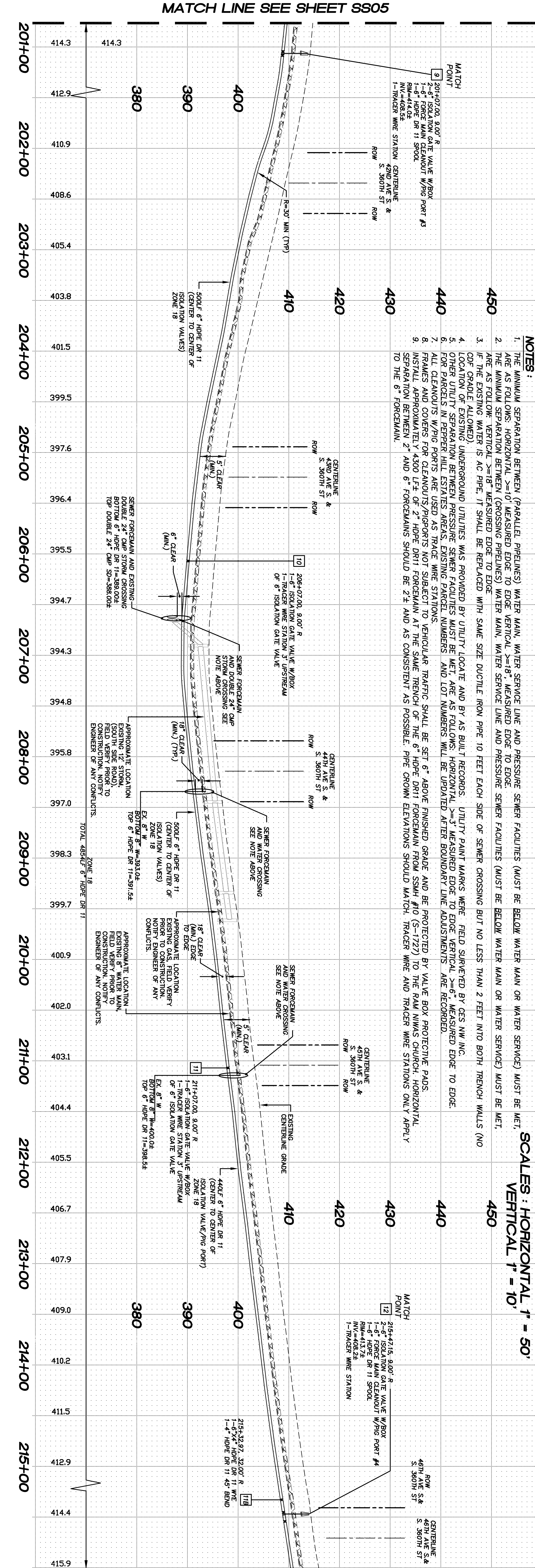

MATCH LINE SEE SHEET SS05

MATCH LINE SEE SHEET SS05

201+00 202+00 203+00 204+00 205+00 206+00 207+00 208+00 209+00 210+00 211+00 212+00 213+00 214+00 215+00

SS06
060255902-SS02-SS06.DWG

PROJECT NO.: 10021
DRAWN BY: JQC
ISSUE DATE: 7-23-2010
SHEET REV: 9-29-2010

LAKEHAVEN UTILITY DISTRICT PROJECT No. 6308021
RAM NIWAS CHURCH
KING COUNTY, WA.
FOR: SATGURU RAM SINGH STANG
15701 138TH PLACE SE
RENTON, WA 98058
PHONE: (206) 304-1911

Pacific Engineering Design, LLC
Civil Engineering and Planning Consultants

15445 53RD AVE. S.
SEATTLE, WA 98188
PHONE: (206) 431-7970
FAX: (206) 388-1648
WEB SITE: PACENG.COM

