

- 5 1-6" ISOLATION GATE VALVE W/BOX
- 6 2-6" ISOLATION GATE VALVE W/BOX  
1-6" FORCE MAIN CLEANOUT W/PIG PORT #2  
1-6" HOPE DR 11 SPOOL
- 7 1-6" ISOLATION GATE VALVE W/BOX
- 1 REPLACE EX. 12" A.C. WATER, INSTALL 20LF 12" D.I. CL50 WATER 10 FEET BOTH SIDES OF SEWER CROSSING.

N.W. 1/4, SEC. 26, T. 21 N., R. 4 E., W.M.

LAKEHAVEN UTILITY DISTRICT	
0 Water Plan	9 Sewer Plan
Dated _____	
APPROVED FOR CONSTRUCTION SUBJECT TO CHANGES VOTED	
<small>The District's review is not a check of any dimension or quantity and will not relieve the Developer from responsibility for errors of any sort. No changes shall be made in the plans except by the consent of the District.</small>	
General Manager/District Engineer	Date _____
<small>This construction plan will expire one year from plan approval date, if construction has not commenced.</small>	

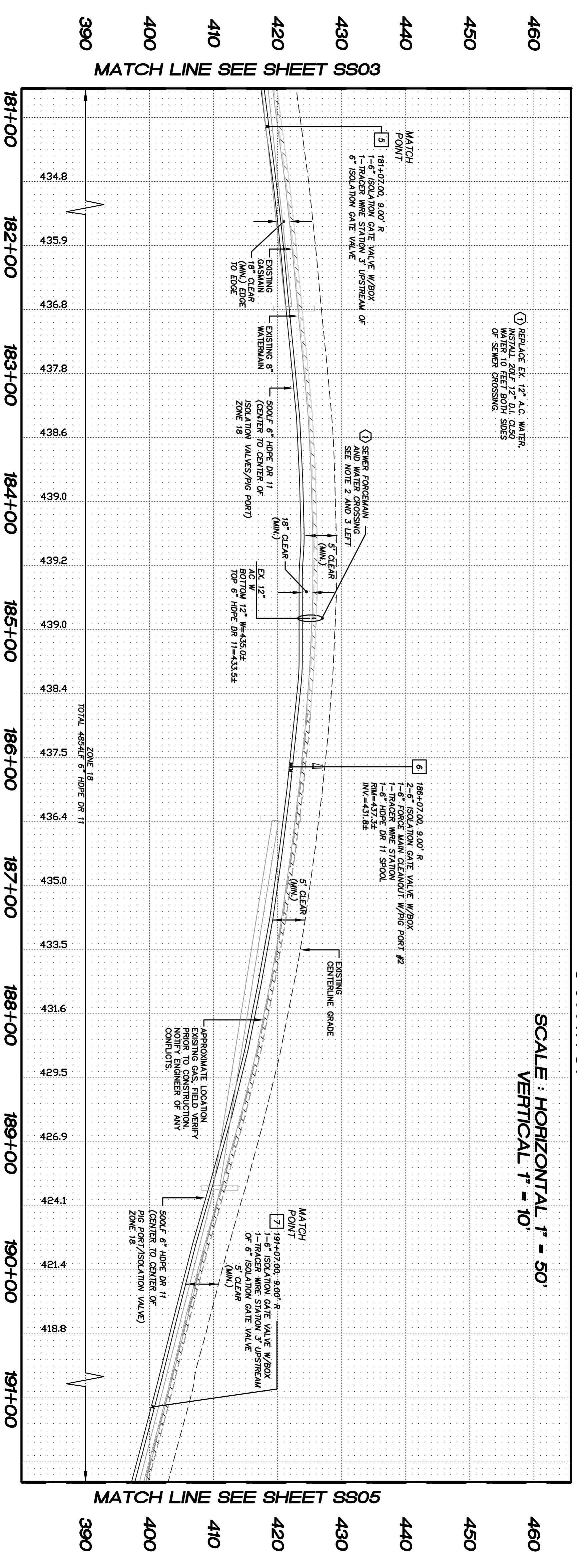
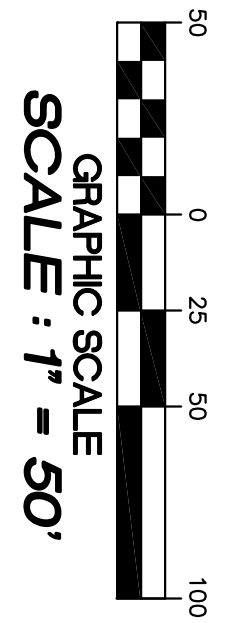
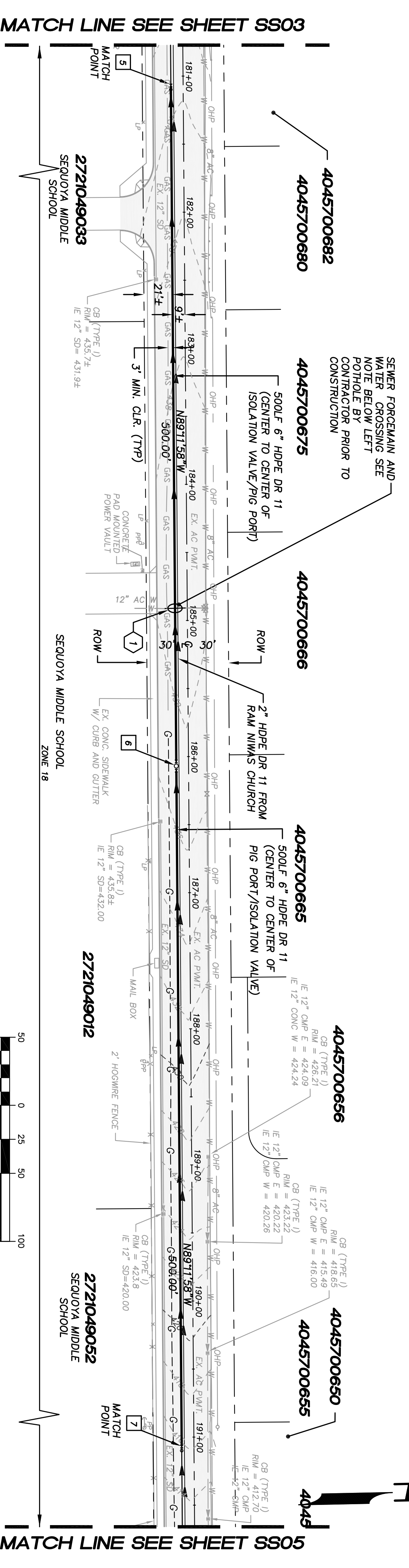
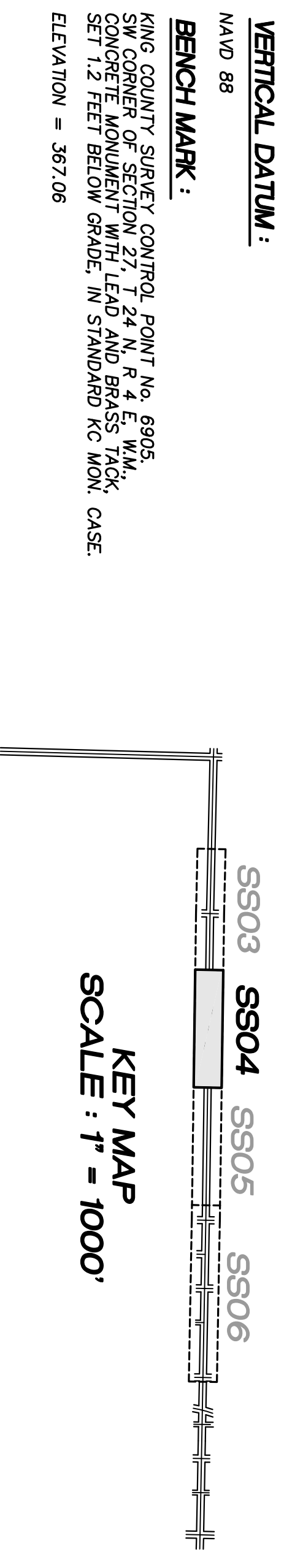

- NOTES:**
- THE MINIMUM SEPARATION BETWEEN (PARALLEL PIPELINES) WATER MAIN, WATER SERVICE LINE AND PRESSURE SEWER FACILITIES (MUST BE BELOW WATER MAIN OR WATER SERVICE) MUST BE MET, ARE AS FOLLOWS: HORIZONTAL >=10 MEASURED EDGE TO EDGE. VERTICAL >=18".
  - THE MINIMUM SEPARATION BETWEEN (CROSSING PIPELINES) WATER MAIN, WATER SERVICE LINE AND PRESSURE SEWER FACILITIES (MUST BE BELOW WATER MAIN OR WATER SERVICE) MUST BE MET, ARE AS FOLLOWS: VERTICAL >=18" MEASURED EDGE TO EDGE.
  - IF THE EXISTING WATER IS AC PIPE, IT SHALL BE REPLACED WITH SAME SIZE DUCTILE IRON PIPE 10 FEET EACH SIDE OF SEWER CROSSING BUT NO LESS THAN 2 FEET INTO BOTH TRENCH WALLS (NO CDF GRADE ALLOWED).
  - LOCATION OF EXISTING UNDERGROUND UTILITIES WAS PROVIDED BY UTILITY LOCATE AND BY AS FIELD SPOOLED BY GCS MARKING.
  - OTHER UTILITY SEPARATION BETWEEN PRESSURE SEWER FACILITIES MUST BE MET, ARE AS FOLLOWS: HORIZONTAL >=3" MEASURED EDGE TO EDGE. VERTICAL >=6" MEASURED EDGE TO EDGE.
  - FOR PARCELS IN PEPPER HILL ESTATES AREAS, EXISTING PARCEL NUMBERS AND LOT NUMBERS WILL BE UPDATED AFTER BOUNDARY LINE ADJUSTMENTS ARE RECORDED.
  - ALL CLEANOUTS W/PIG PORTS ARE USED AS TRACER WIRE STATIONS.
  - CLEANOUTS W/PIG PORTS ARE USED AS TRACER WIRE STATIONS ONLY APPLY TO THE 6" FORCE MAIN.
  - INSTALL APPROXIMATELY 4300 LF. OF 2" HOPE DR11 FOREMAN AT THE SAME TRENCH OF THE 6" HOPE DR11 FOREMAN FROM SSMH #10 (S-1727) TO THE RAM NIWAS CHURCH. HORIZONTAL SEPARATION BETWEEN 2" AND 6" FOREMANS SHOULD BE 2.4' AND AS CONSISTENT AS POSSIBLE. PIPE CROWN ELEVATIONS SHOULD MATCH, TRACER WIRE AND TRACER WIRE STATIONS ONLY APPLY TO THE 6" FOREMAN.

060255902-SS02-SS06.DWG  
**SS04**

**FORCE MAIN  
SAHJARI SEWER  
S 360TH ST  
STA. 181+07.00 TO  
STA. 191+07.00  
PLAN AND PROFILE**

**LAKEHAVEN UTILITY DISTRICT PROJECT No. 6308021  
RAM NIWAS CHURCH**  
KING COUNTY, WA.  
FOR: SATGURU RAM SINGH STANG  
15701 138TH PLACE SE  
RENTON, WA 98058  
PHONE: (206) 304-1911

**Pacific  
Engineering  
Design, LLC**  
Civil Engineering and  
Planning Consultants

15445 53RD AVE. S,  
SEATTLE, WA 98188  
PHONE: (206) 431-7970  
FAX: (206) 388-1648  
WEB SITE: PACENG.COM

