

SE. 1/4, SEC. 27, T. 21 N., R. 4 E., W.M.

S. 360TH ST.

46TH AVE S.
(UNIMPROVED)

45TH AVE S.
(UNIMPROVED)

S. 362ND ST.
(UNIMPROVED)

LAKHAVEN UTILITY DISTRICT	0 Water Plan	9 Sewer Plan
Date: _____		
APPROVED FOR CONSTRUCTION		
SUBJECT TO CHANGES NOTED		
<small>The District's review is not a check of any dimension or quantities and will not relieve the Developer from responsibility for errors of any sort. No changes shall be made in the plans except by the consent of the District.</small>		
General Manager/District Engineer	Date	
<small>This construction plan will expire one year from plan approval date. If construction has not commenced.</small>		

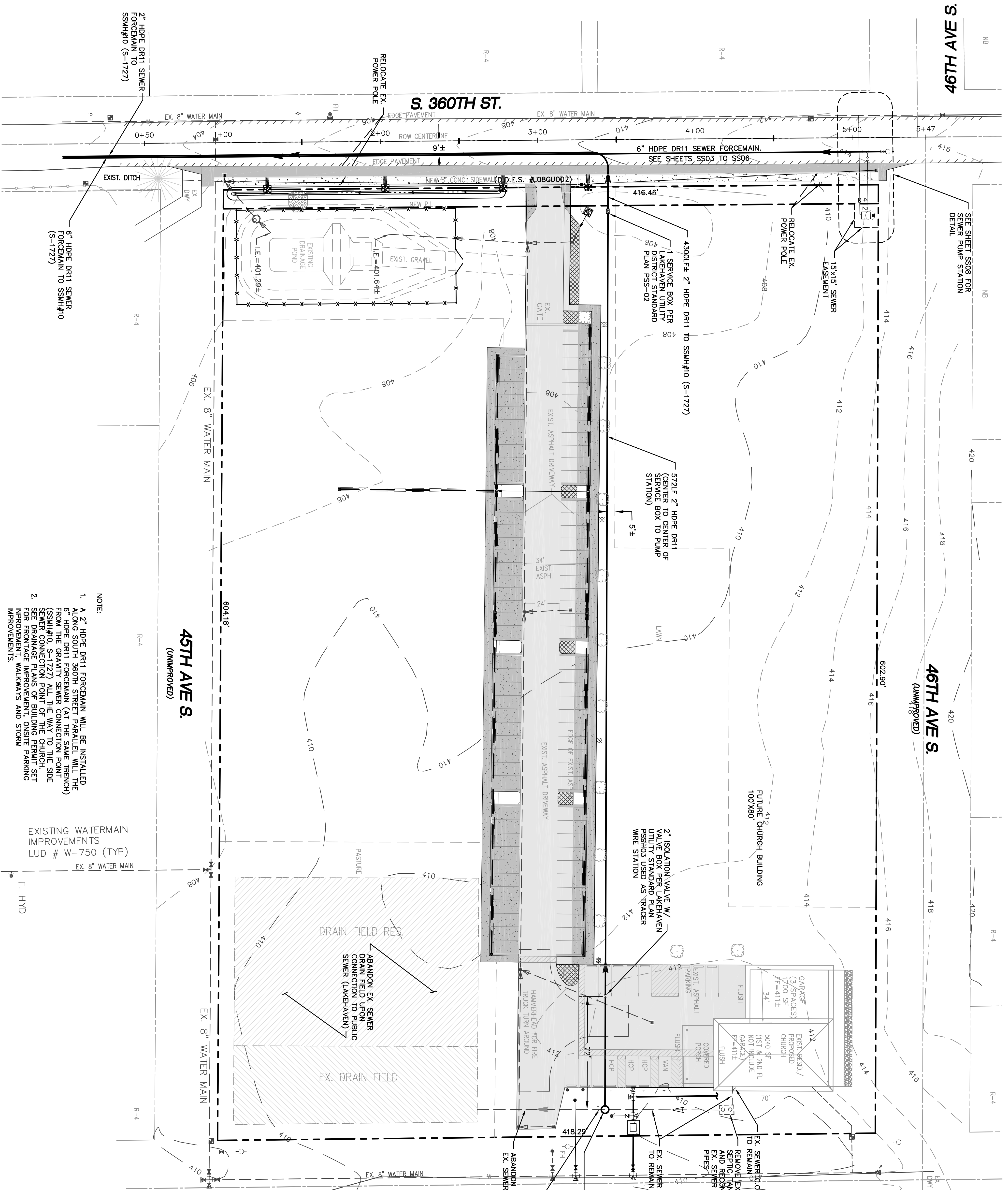
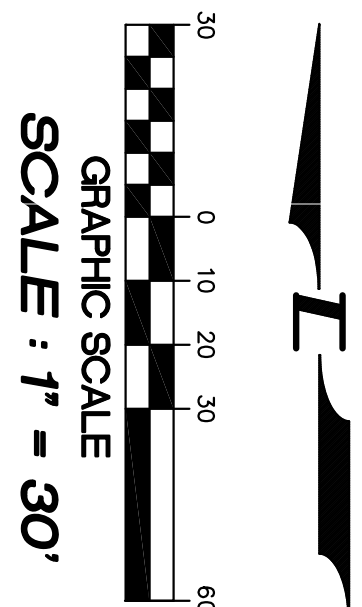

- NOTE:
1. A 2" HDPE DR11 FORCEMAIN WILL BE INSTALLED ALONG SOUTH 360TH STREET PARALLEL WITH THE 6" HDPE DR11 FORCEMAIN (AT THE SAME TRENCH) FROM THE GRAVITY SEWER CONNECTION POINT (SSMH#10, S-1722) ALL THE WAY TO THE SIDE SEWER CONNECTION POINT OF THE CHURCH. SEE DRAINAGE PLANS FOR BUILDING PERMIT SET IMPROVEMENTS WALKWAYS AND STORM IMPROVEMENTS.
 2. SEE DRAINAGE PLANS FOR BUILDING PERMIT SET IMPROVEMENTS WALKWAYS AND STORM IMPROVEMENTS.

EXISTING WATERMAIN IMPROVEMENTS
LUD # W-750 (TYP)
F. HYD

SS02
10021.SS01.DWG

SANITARY SEWER DESIGN

PROJECT NO.: 10021
DRAWN BY: CJB
ISSUE DATE: 7-23-2010
SHEET REV.: 9-20-2010

LAKHAVEN UTILITY DISTRICT PROJECT No. 6308021
RAM NIWAS CHURCH
KING COUNTY, WA.

FOR:
SATGURU RAM SINGH STANG
15701 138TH PLACE SE
RENTON, WA 98058
PHONE: (206) 304-1911

Pacific Engineering Design, LLC
Civil Engineering and Planning Consultants

15445 53RD AVE. S.
SEATTLE, WA 98188
PHONE: (206) 431-7970
FAX: (206) 388-1648
WEB SITE: PACENG.COM

