

THE SW CORNER OF THE SW 1/4, NW 1/4, SEC. 12, TWP. 23 N., RGE. 04 E., W.M.

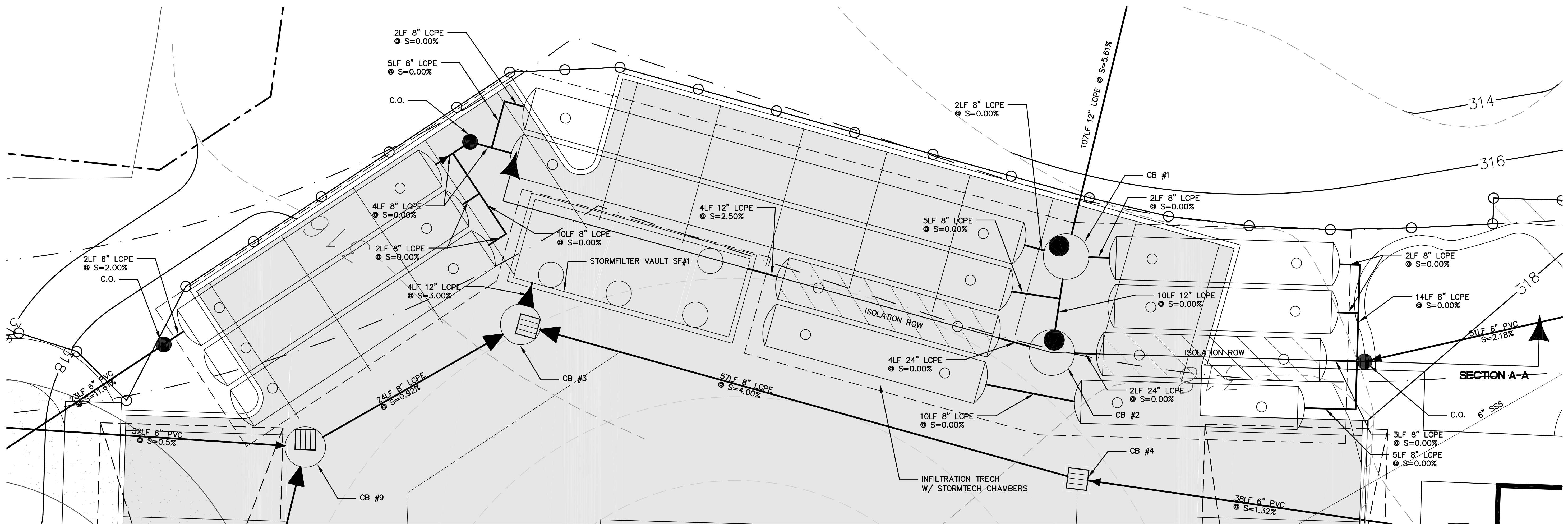

**INFILTRATION TRENCH PLAN**  
SCALE: 1"=5'

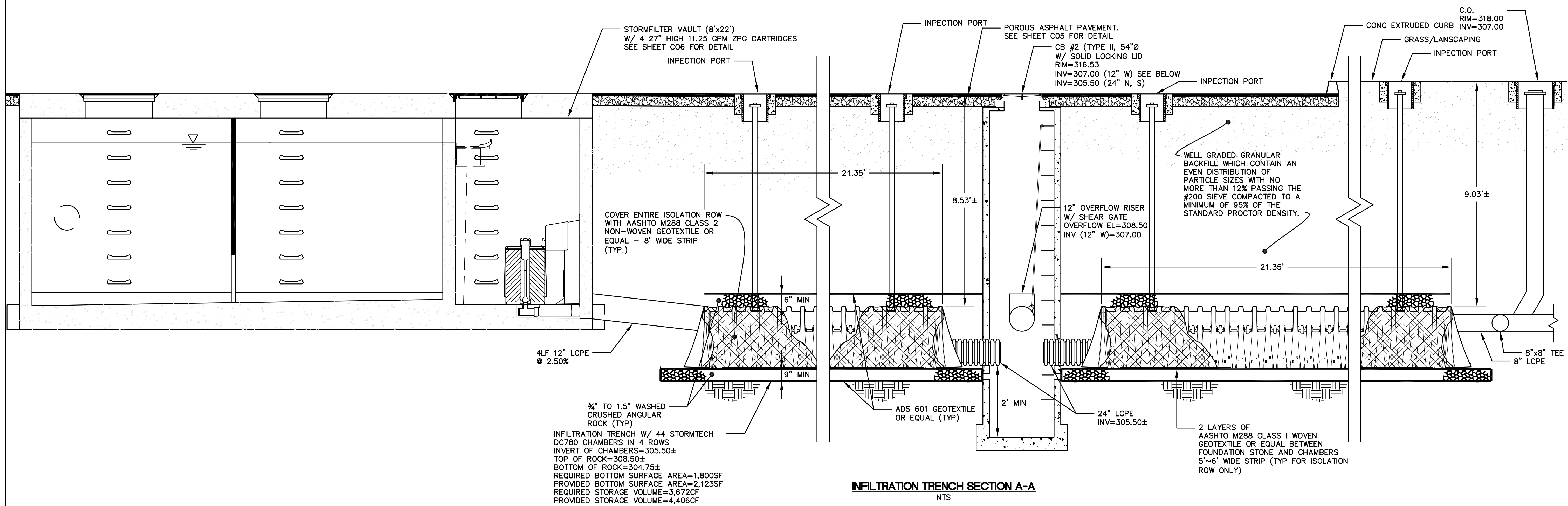

**INFILTRATION TRENCH SECTION A-A**  
NTS

4LF 12" LCPE  
S=2.50%

3/4" TO 1.5" WASHED CRUSHED ANGULAR ROCK (TYP.)

INFILTRATION TRENCH W/ 44 STORMTECH DC780 CHAMBERS IN 4 ROWS  
INVERT OF CHAMBERS=305.50±  
TOP OF ROCK=308.50±  
BOTTOM OF ROCK=304.75±  
REQUIRED BOTTOM SURFACE AREA=1,800SF  
PROVIDED BOTTOM SURFACE AREA=2,123SF  
REQUIRED STORAGE VOLUME=3,672CF  
PROVIDED STORAGE VOLUME=4,406CF

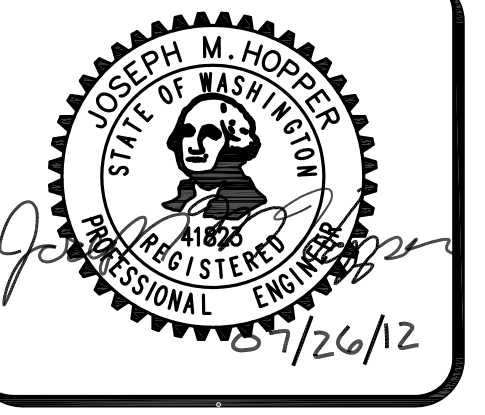

**Taylor Creek Apartments**  
KING COUNTY

RYAN GROUWS  
G3 INVESTMENTS, LLC  
P.O. BOX 78448  
SEATTLE, WA 98178  
Phone: (425) 255-5747  
Fax: (425) 255-4882

PROJECT NO.: 10018  
DRAWN BY: ENM  
ISSUE DATE: 2010-12-01  
SHEET REV.: 2012-07-26

STORM DRAIN SECTIONS

10018RSEC02.DWG  
**C07**  
SHEET 07 OF 11