

THE SW CORNER OF THE SW 1/4, NW 1/4, SEC. 12, TWP. 23 N., RGE. 04 E., W.M.

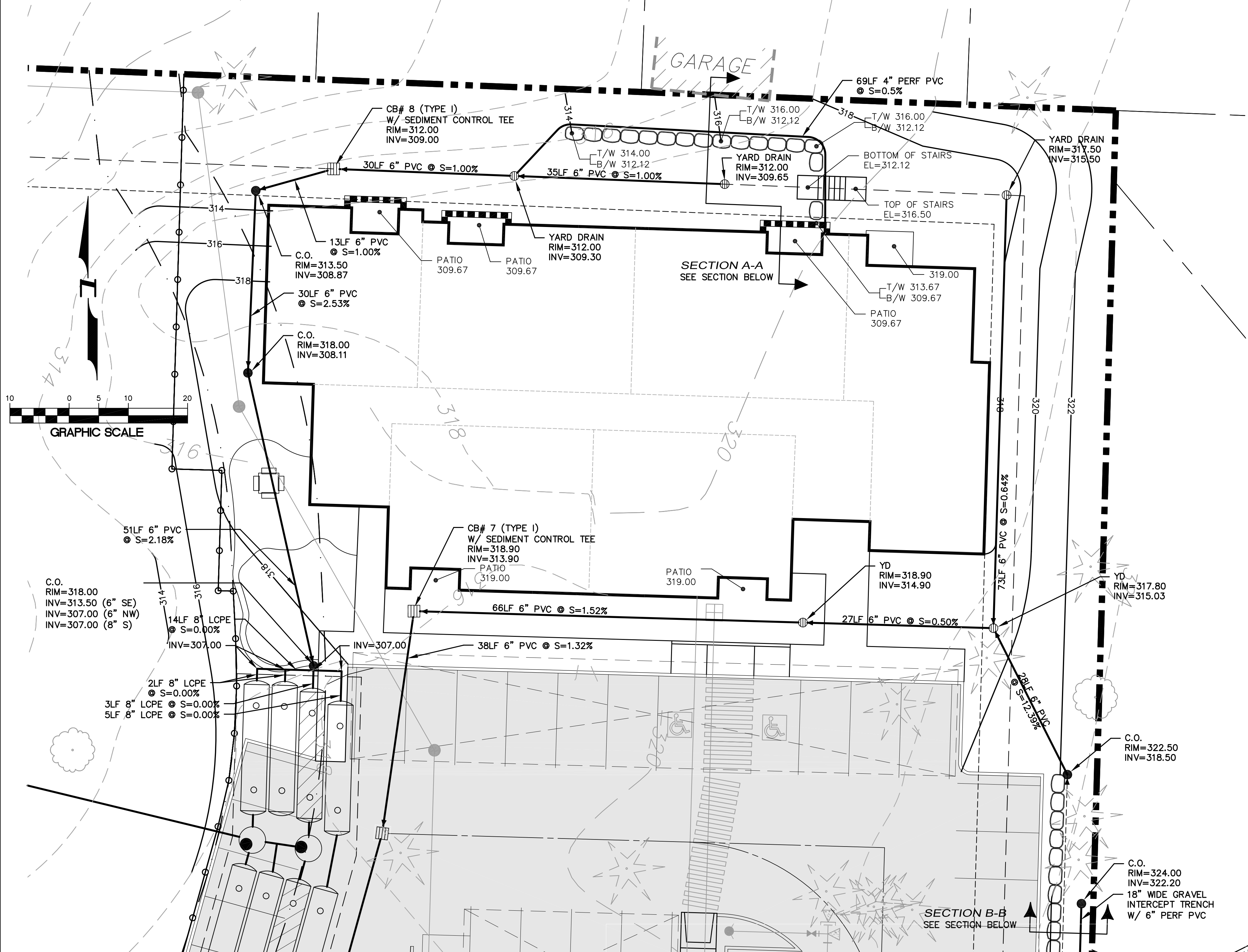

**STRUCTURAL NOTES:**

1. THESE PLANS ARE APPROVED FOR STANDARD ROAD AND DRAINAGE IMPROVEMENTS ONLY. PLANS FOR STRUCTURES SUCH AS BRIDGES, VAULTS, AND RETAINING WALLS REQUIRE A SEPARATE REVIEW AND APPROVAL BY DDES PRIOR TO CONSTRUCTION (KCC 16.04, 16.70, 14.20).
2. ROCKERIES ARE CONSIDERED TO BE A METHOD OF BANK STABILIZATION AND EROSION CONTROL. ROCKERIES SHALL NOT BE CONSTRUCTED TO SERVE AS RETAINING WALLS. ALL ROCKERIES IN COUNTY ROAD RIGHT-OF-WAY SHALL BE CONSTRUCTED IN ACCORDANCE WITH KCRS. ROCKERIES OUTSIDE OF ROAD RIGHT-OF-WAY SHALL BE CONSTRUCTED IN ACCORDANCE WITH THE INTERNATIONAL BUILDING CODE.

**Rockery Standards**  
For rockeries not located in the public way

**Applicant:** \_\_\_\_\_  
**Activity:** \_\_\_\_\_  
**Engineer:** \_\_\_\_\_  
(When required by item #3)

**General Notes:**

1. Rockeries 4' and over in height require a building permit.
2. For rockeries between 4' and 6' high, the installer or contractor shall provide a letter to the building inspector prior to final inspection certifying that the subgrade and drainage have been prepared in accordance with the standards.
3. Rockeries 6' and over in height require engineering supervision by a special inspector per IBC 1704.1, which at a minimum shall consist of inspection and written certification of subgrade, placement of base course and drainage and finished rockery.
4. Rockeries over 6' in height must meet setback requirements in residential zones.
5. Rocks shall be sound and have a minimum density of 160 pounds per cubic foot.
6. The long dimension of all rocks shall be placed perpendicular to the wall. Each rock should bear on two rocks in the tier below.
7. Improved walking surfaces above and adjacent to rockeries over 30" in height shall be protected by a guardrail conforming to IRC R312 and IBC 1013, 2009 editions.
8. **Rockeries are erosion control structures, not retaining walls.** Native material must be stable and freestanding in cut face.
9. Any deviation in design or placement of adjacent structures must be submitted with the seal of a Civil Engineer currently licensed in the State of Washington.



**Pacific Engineering Design, LLC**  
Civil Engineering & Planning Consultants

Phone: (206) 431-7970 Fax: (206) 388-1648  
15445 53RD Ave. S. Seattle, WA 98188 www.paceeng.com

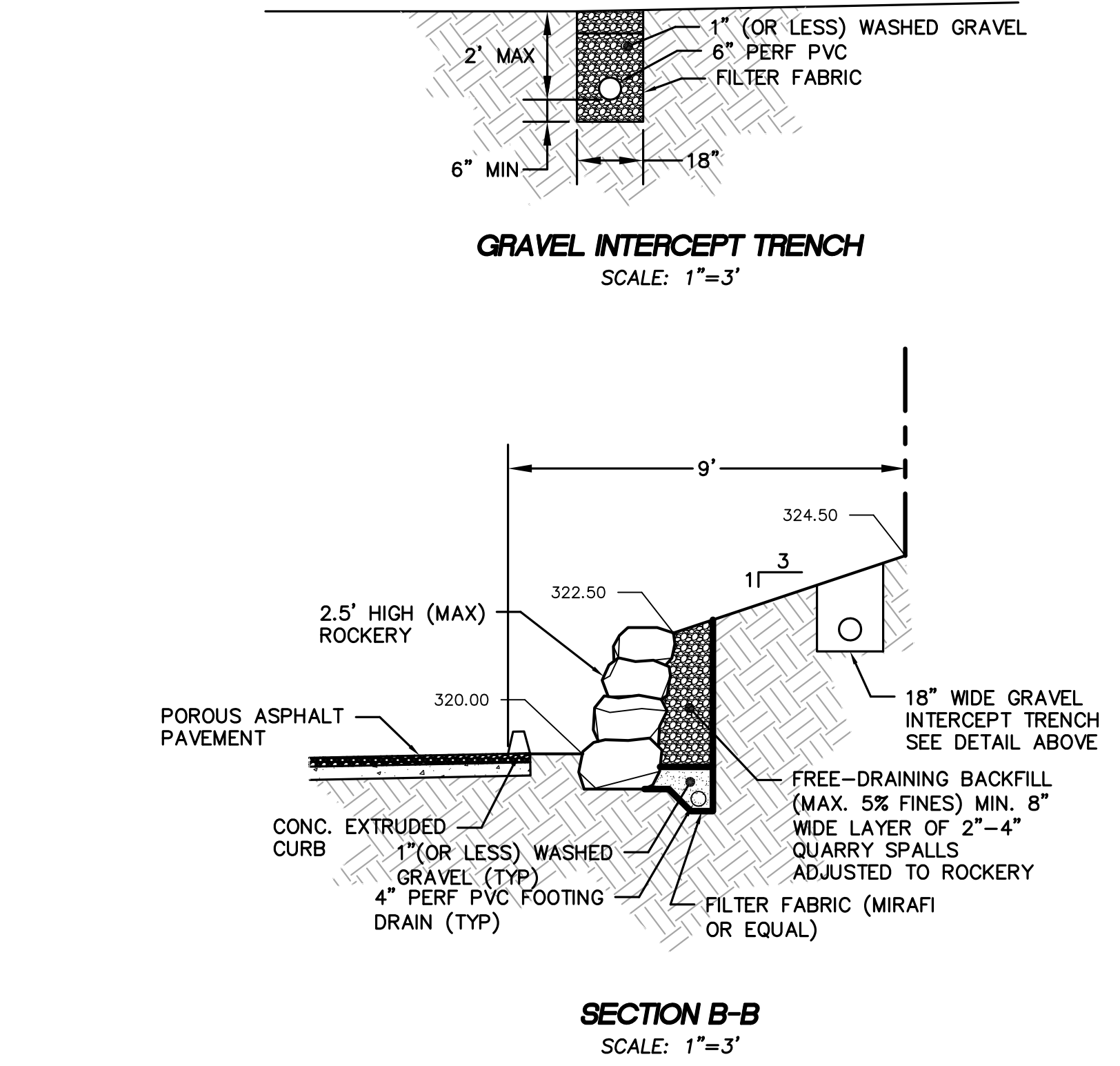
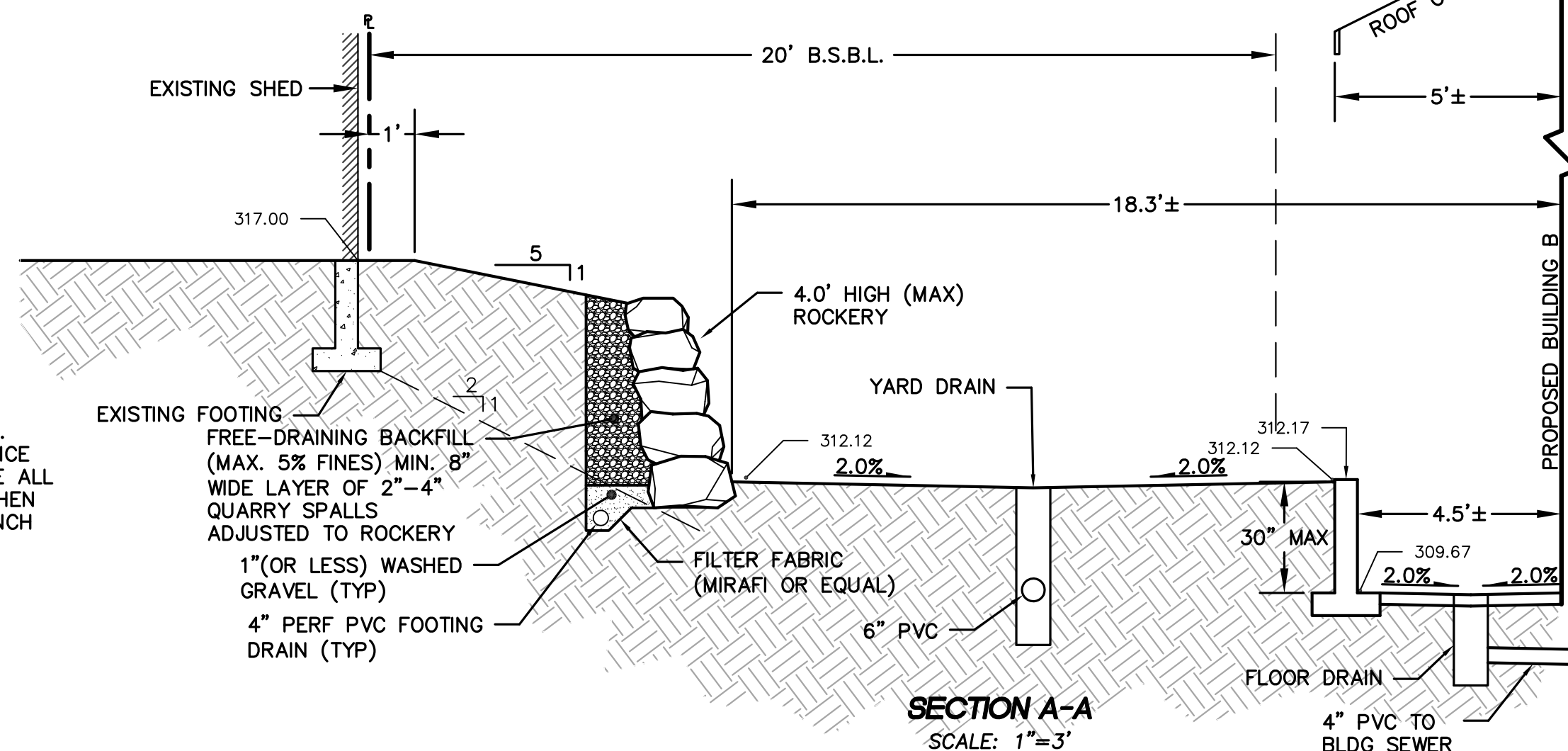
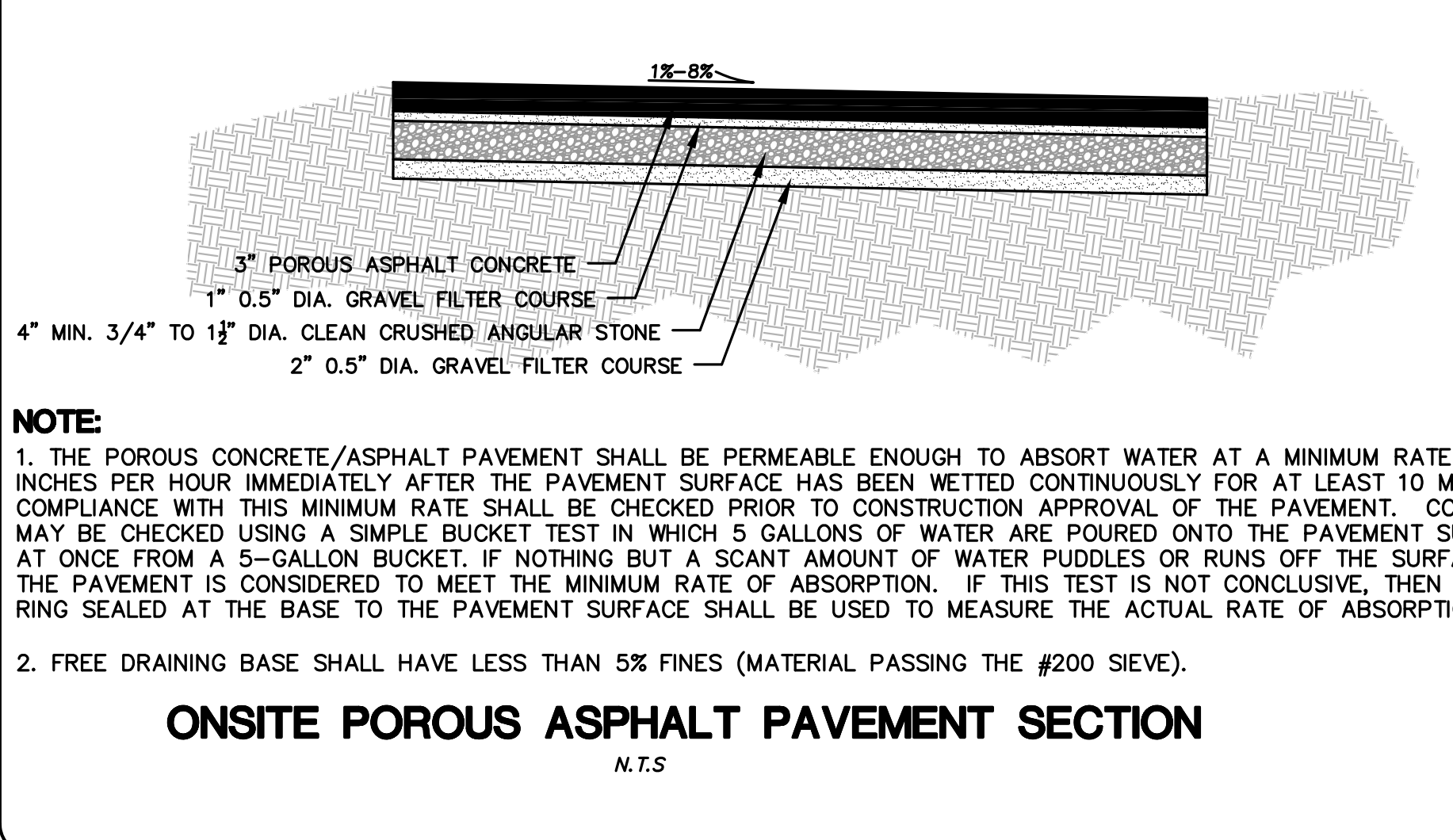

**Taylor Creek Apartments**

KING COUNTY

RYAN GROUWS  
G3 INVESTMENTS, LLC  
P.O. BOX 78448  
SEATTLE, WA 98178  
Phone: (425) 255-5747  
Fax: (425) 255-4882

PROJECT NO.: 10018  
DRAWN BY: ENM  
ISSUE DATE: 2010-12-01  
SHEET REV.: 2012-07-26

GRADING DETAILS  
SECTIONS AND  
NOTES

10018GR01.DWG  
**C05**  
SHEET 05 OF 11