

A PORTION OF THE SE 1/4, SEC. 23, TWP. 23 N., RGE. 5 E., W.M. AND A PORTION OF THE SE 1/4, SEC. 24, TWP. 23 N., RGE. 5 E., W.M.

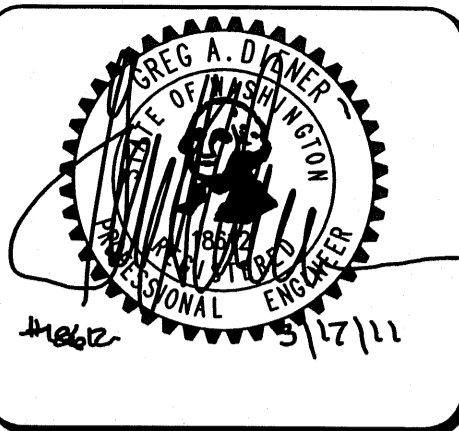
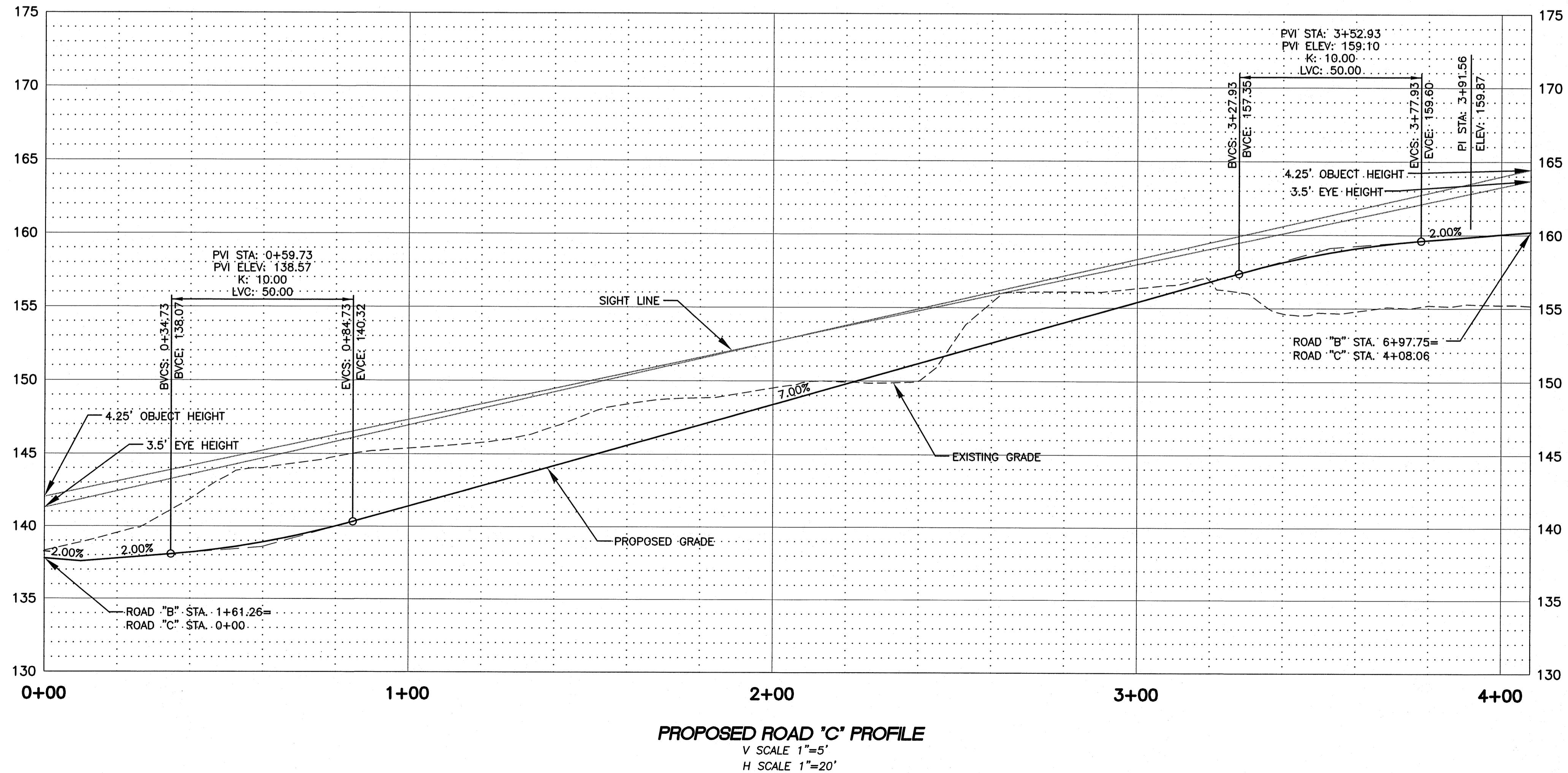
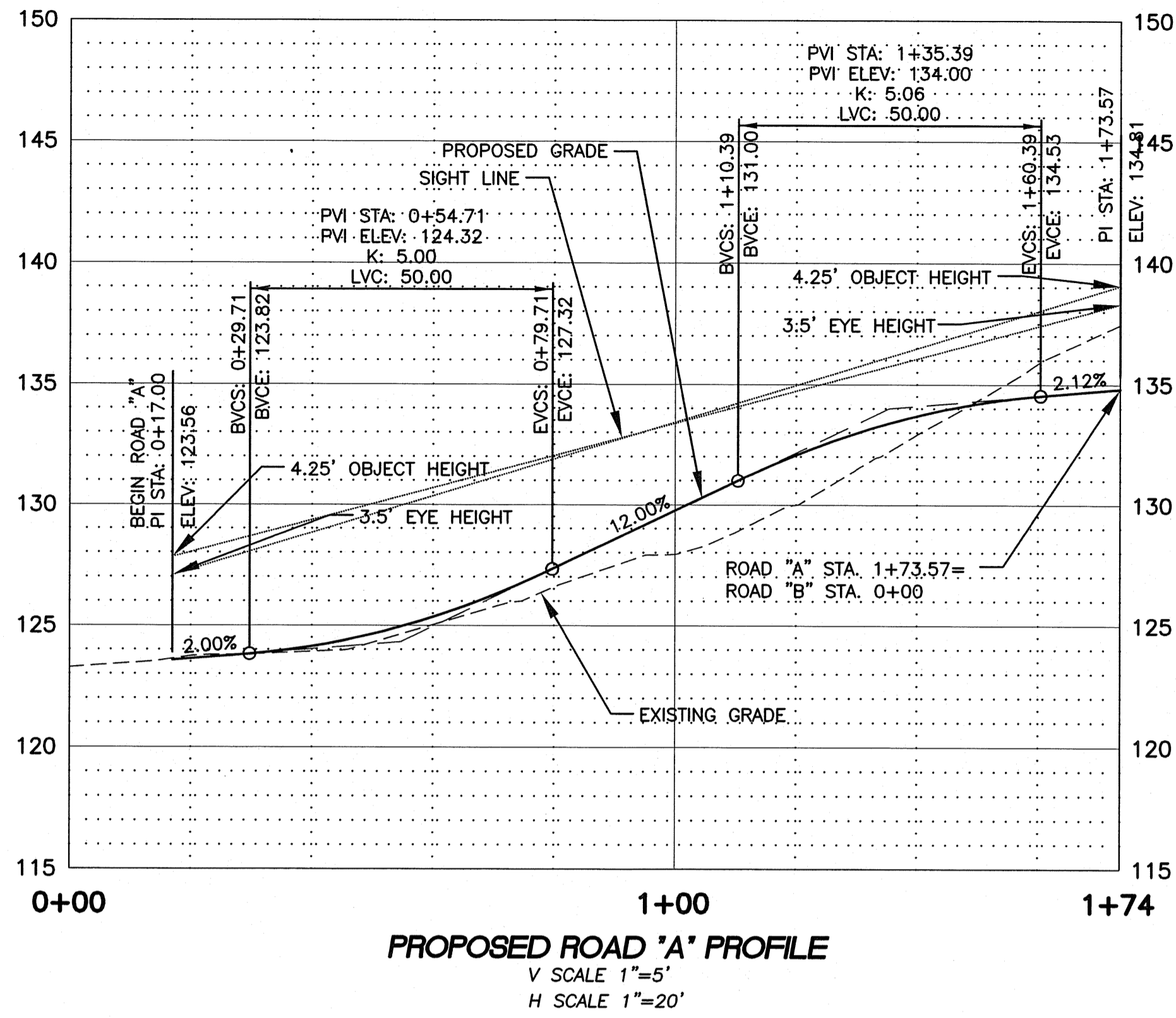

Phone: (206) 431-7970 Fax: (206) 388-1648  
 15445 53rd Ave. S. Seattle, WA 98188 www.paceng.com

**MCCORMICK PLAT**  
 CITY OF RENTON

FOR:  
 ROBERT MCCORMICK  
 161 MAPLEWAY ROAD  
 BELLEVUE, WA 98004  
 PHONE: (206) 846-2219

PROJECT NO.: 07093  
 DRAWN BY: CJB  
 ISSUE DATE: 12-13-2010  
 SHEET REV.:

ROAD A AND C PROFILES

**P06**  
 SHEET 07 OF 12