

A PORTION OF THE SE 1/4, SEC. 23, TWP. 23 N., RGE. 5 E., W.M. AND A PORTION OF THE SE 1/4, SEC. 24, TWP. 23 N., RGE. 5 E., W.M.

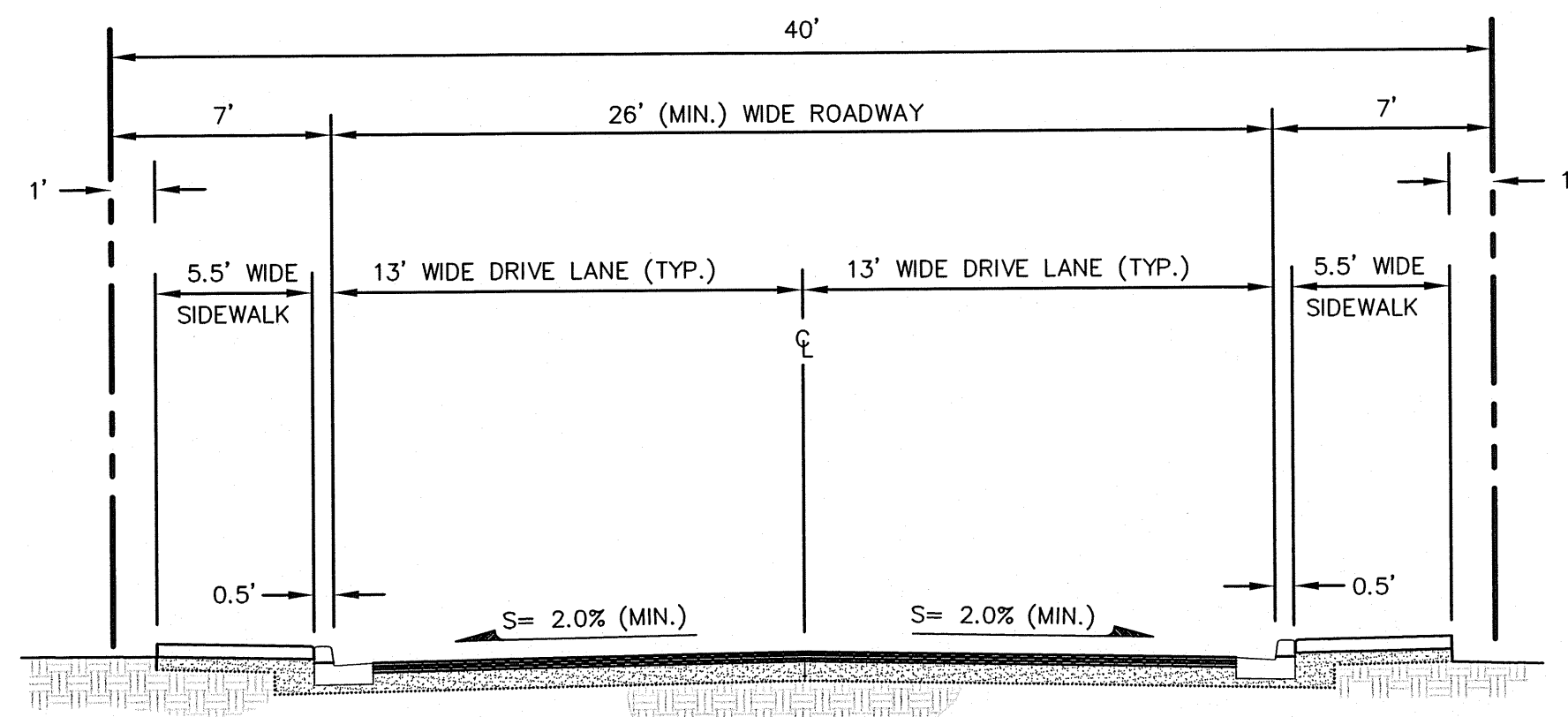

ROAD A CROSS SECTION
NTS

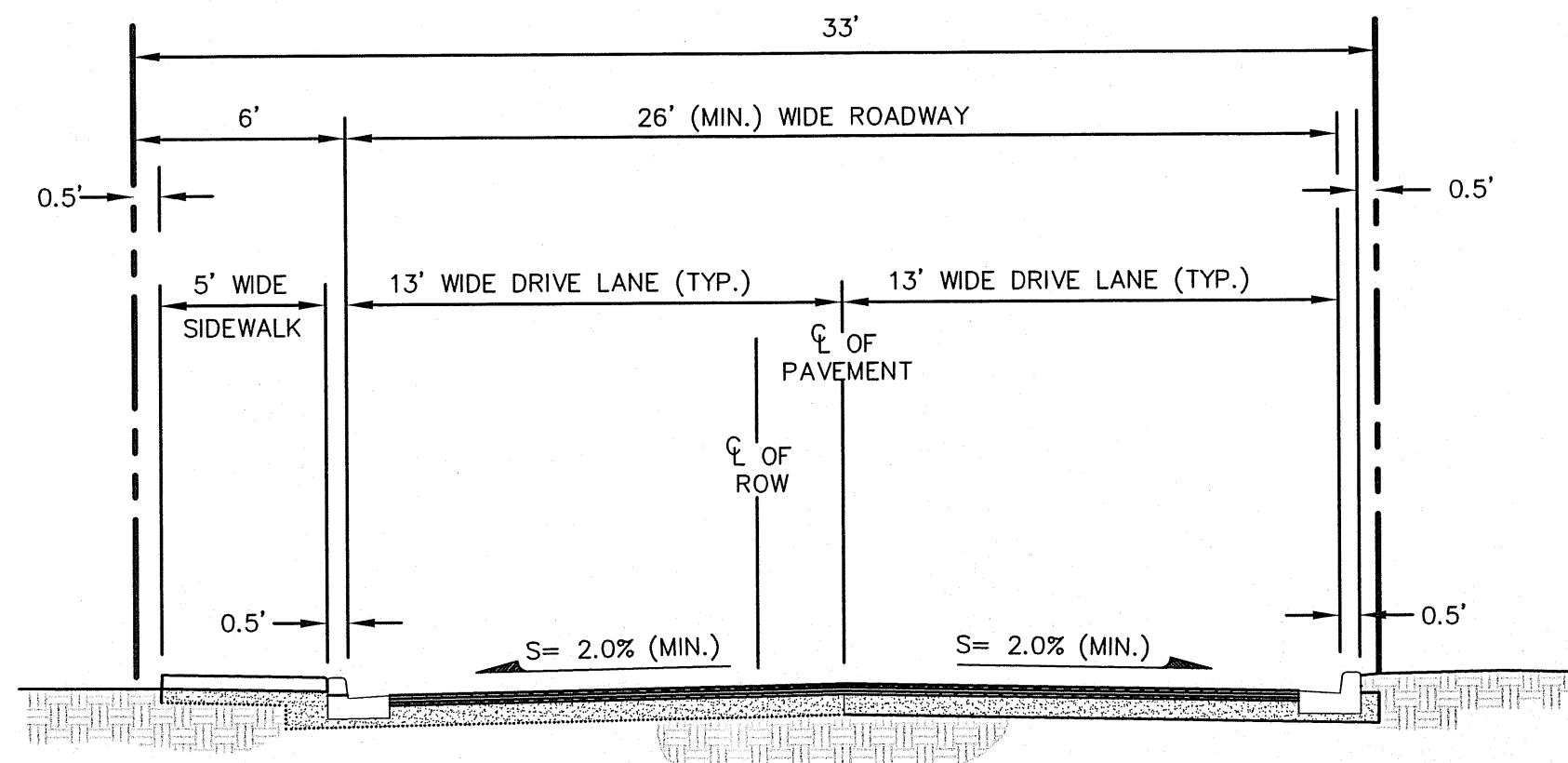

ROAD B CROSS SECTION
NTS

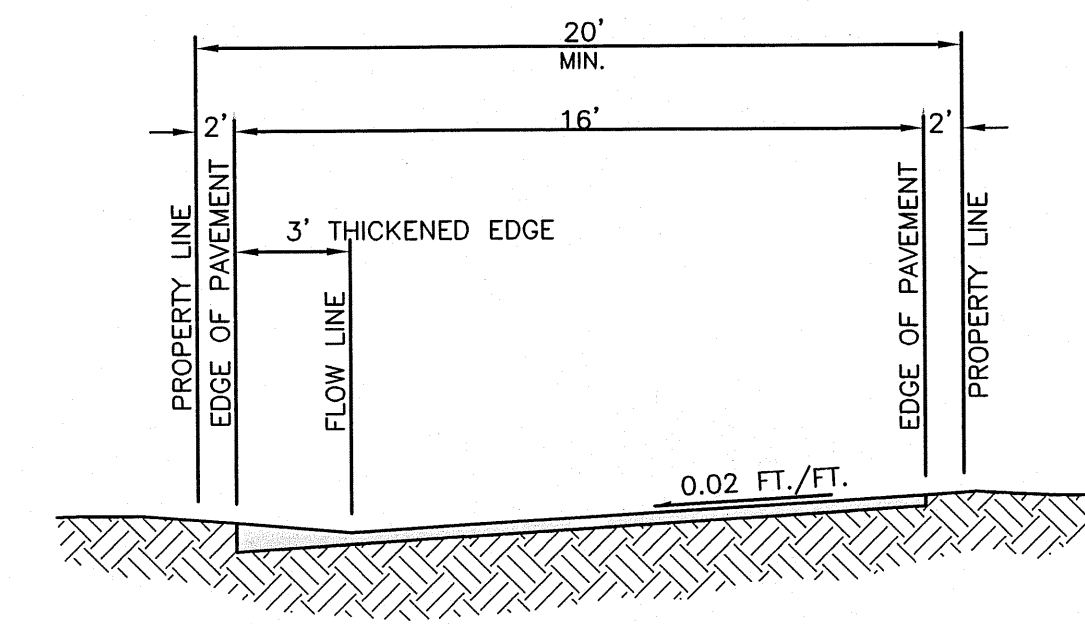

ROAD C CROSS SECTION
NTS

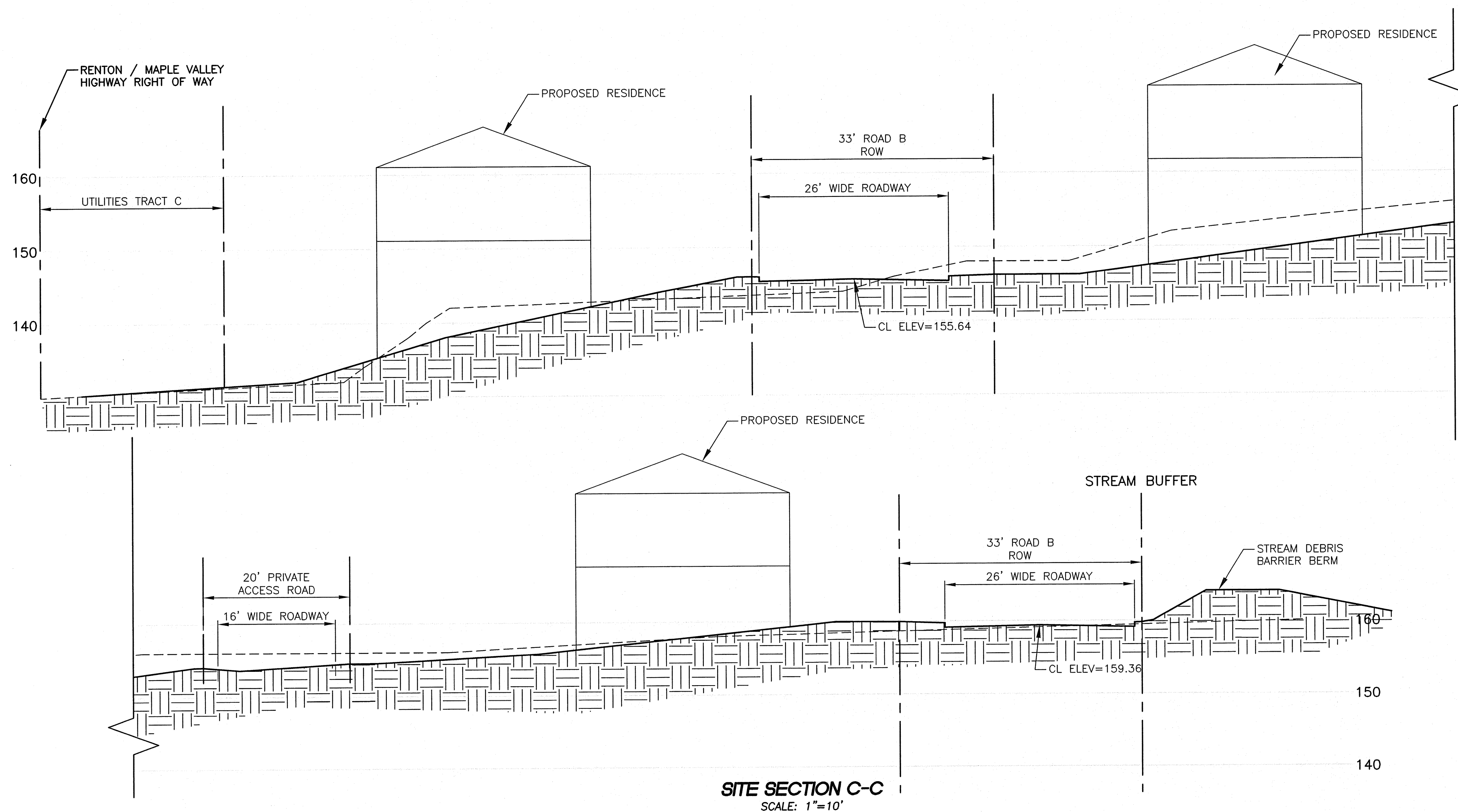

SITE SECTION C-C
SCALE: 1"=10'



**Pacific Engineering
Design, LLC**
Civil Engineering &
Planning Consultants

Phone: (206) 431-7970 Fax: (206) 388-1648
15445 53RD Ave. S. Seattle, WA 98188 www.paceng.com

MCCORMICK PLAT
CITY OF RENTON

FOR:
ROBERT MCCORMICK
181 MAPLE VALLEY ROAD
SEALAH, WA 98142
PHONE: (509) 945-2219

PROJECT NO.: **07093**
DRAWN BY: **CJB**
ISSUE DATE: **12-13-2010**
SHEET REV.:

CONCEPTUAL
ROAD AND
SITE SECTION

P05
SHEET 06 OF 12