

N.W. 1/4, SEC. 26, T. 21 N., R. 4 E., W.M.

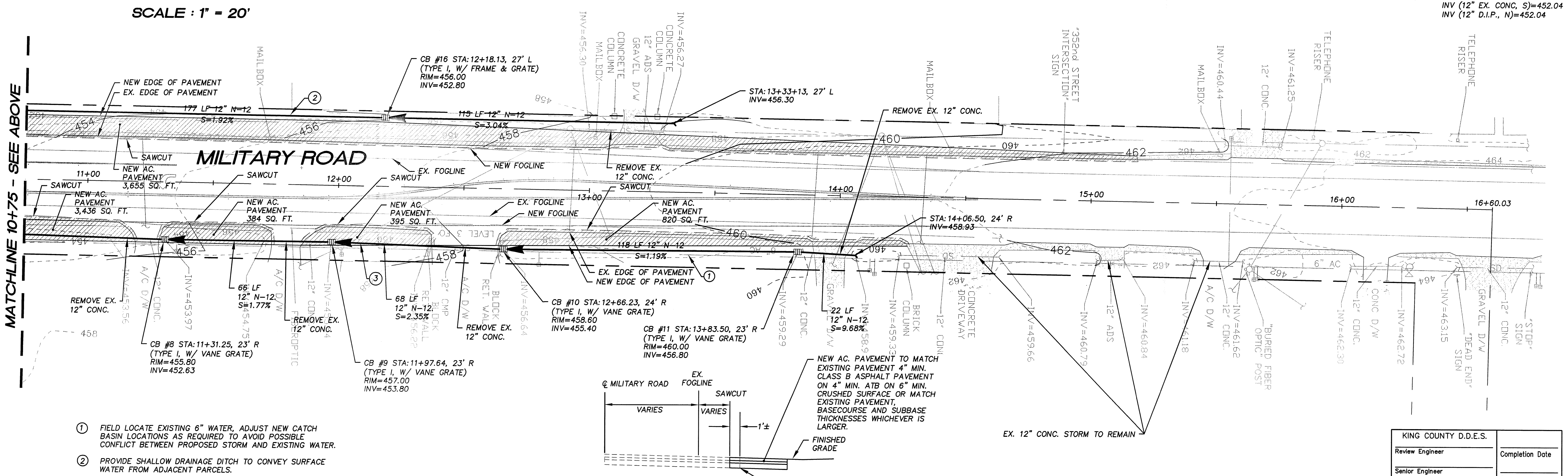

- ① FIELD LOCATE EXISTING 6" WATER, ADJUST NEW CATCH BASIN LOCATIONS AS REQUIRED TO AVOID POSSIBLE CONFLICT BETWEEN PROPOSED STORM AND EXISTING WATER.
- ② PROVIDE SHALLOW DRAINAGE DITCH TO CONVEY SURFACE WATER FROM ADJACENT PARCELS.
- ③ PROVIDE SHALLOW DRAINAGE SWALE ALONG EDGE OF PAVEMENT

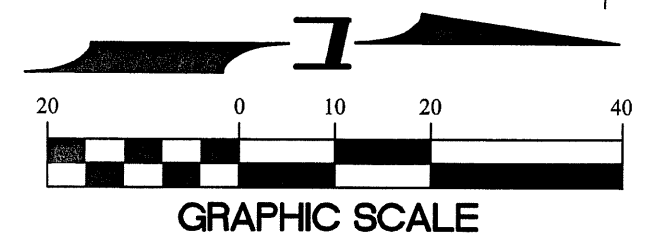
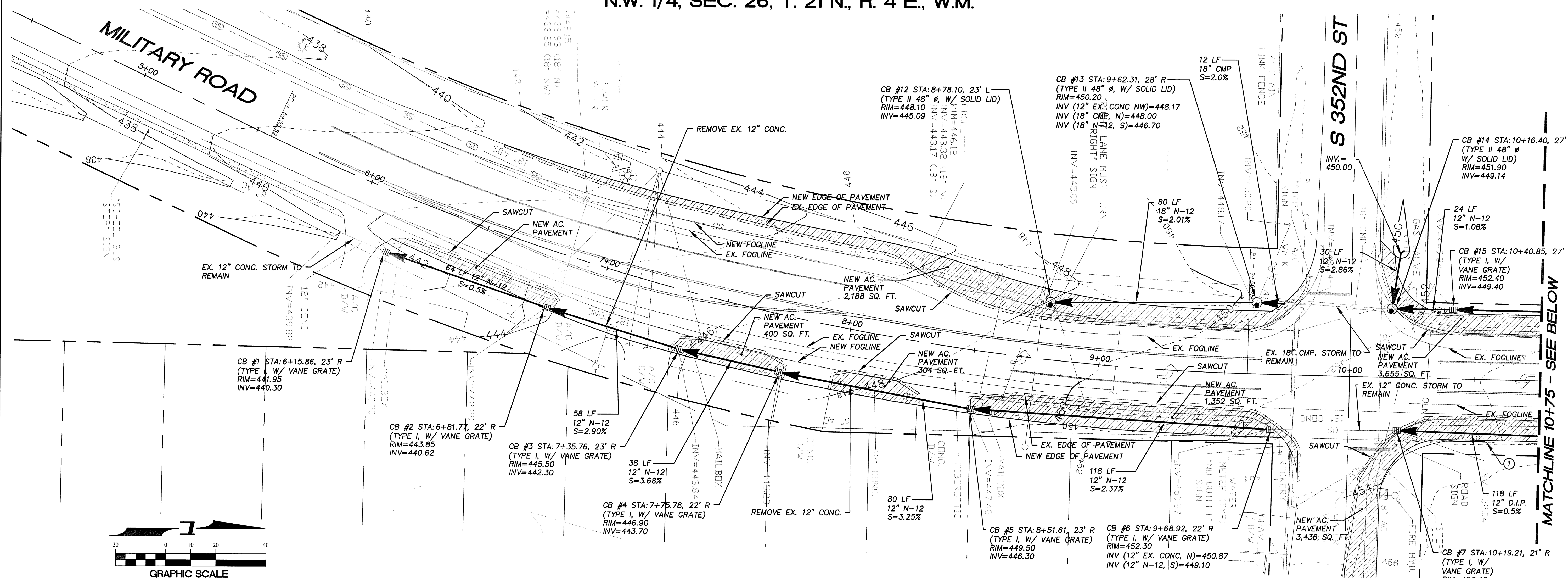
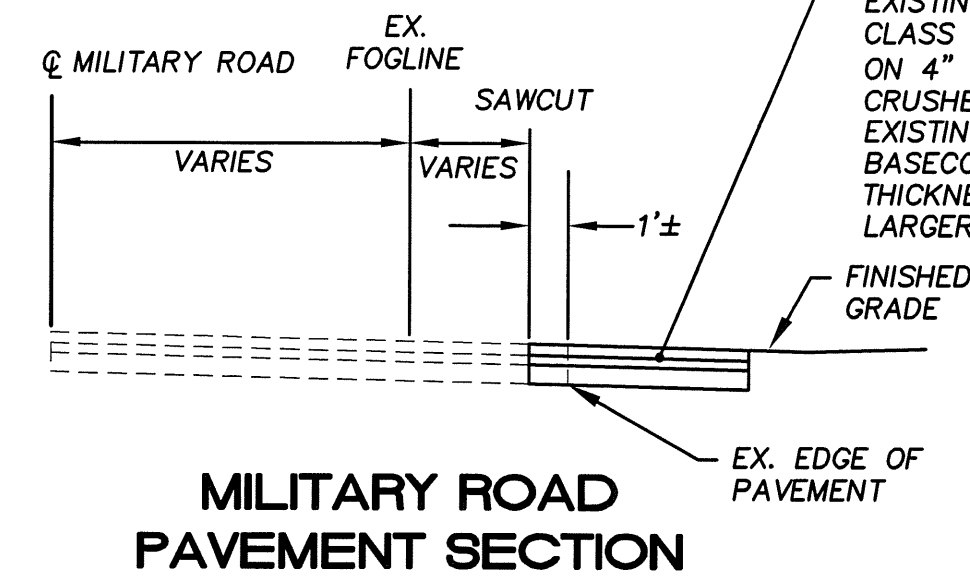

15445 63RD AVE. S.
SEATTLE, WA 98188
PHONE: (206) 431-7970
FAX: (206) 388-1648
WEB SITE: PACENG.COM

Pacific Engineering Design, LLC
Civil Engineering and Planning Consultants

PEPPER HILL ESTATES
KING COUNTY, WA.

FOR:
PACIFIC HOUSING GROUP I, LLC
15400 5TH AVE. SUITE 2200
SEATTLE, WA 98148
PHONE: (206) 521-5979 FAX: (206) 224-2880

KING COUNTY ACTIVITY NO. L07SR068, L6CG4101, L06RW031

PROJECT NO.: 05052
DRAWN BY: ENM
ISSUE DATE: 11-28-07
SHEET REV.: 11-20-09

PLAN FOR MILITARY ROAD

05052ROW-RW31.DWG
R31

KING COUNTY D.D.E.S.	
Review Engineer	Completion Date
Senior Engineer	Completion Date
WOLLY A. JOHNSON, P.E. DEVELOPMENT ENGINEER	Approval Date
Comments:	