

N.W. 1/4, SEC. 26, T. 21 N., R. 4 E., W.M.

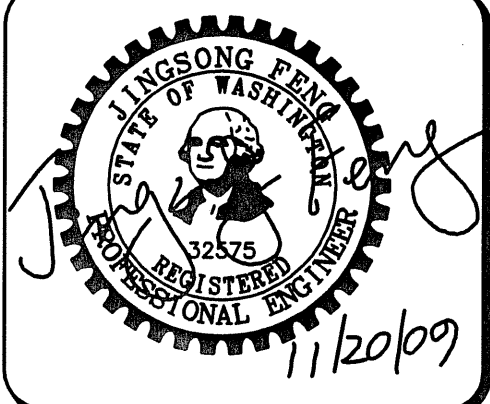

15445 53RD AVE. S.  
SEATTLE, WA 98188  
PHONE: (206) 431-7970  
FAX: (206) 388-1648  
WEB SITE:  
PACENG.COM

Pacific  
Engineering  
Design, LLC

Civil Engineering and  
Planning Consultants

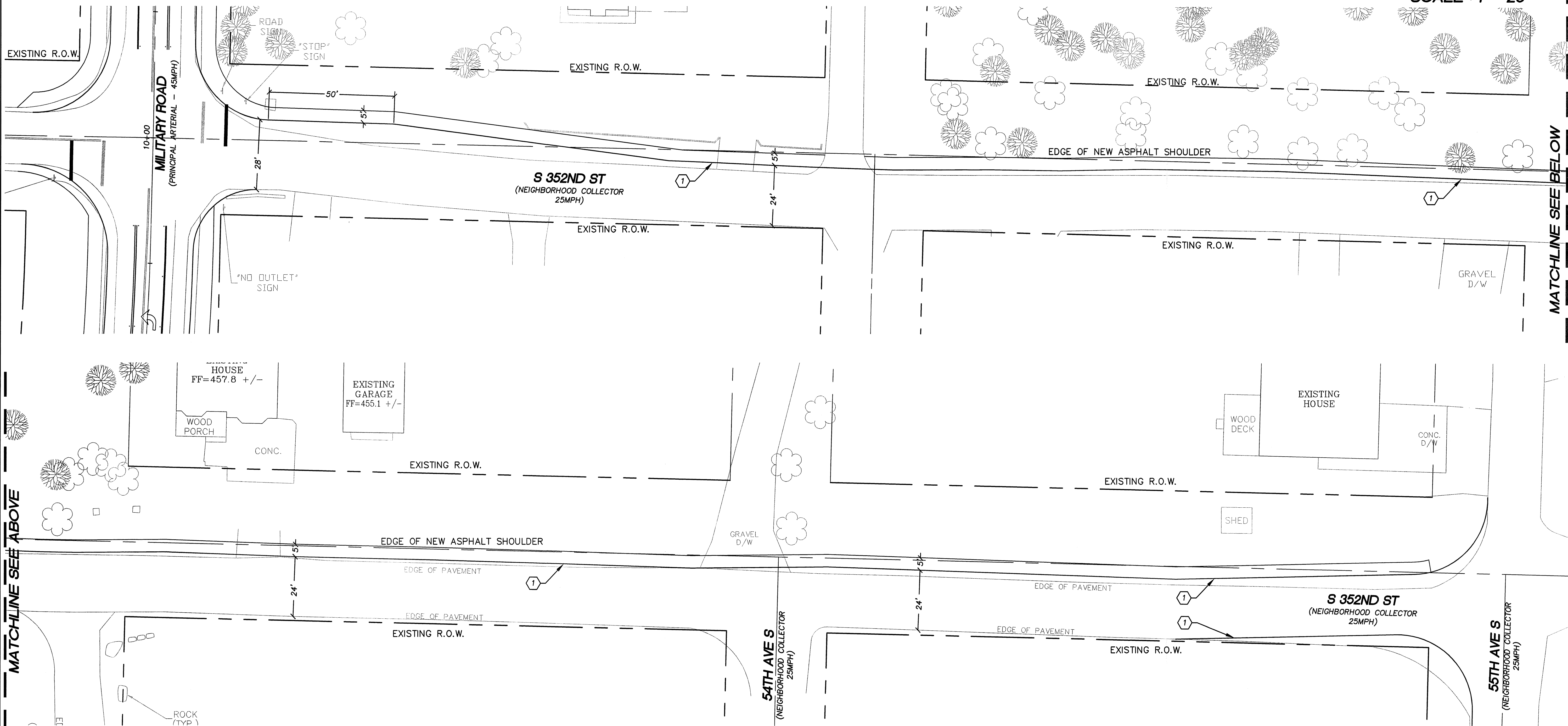
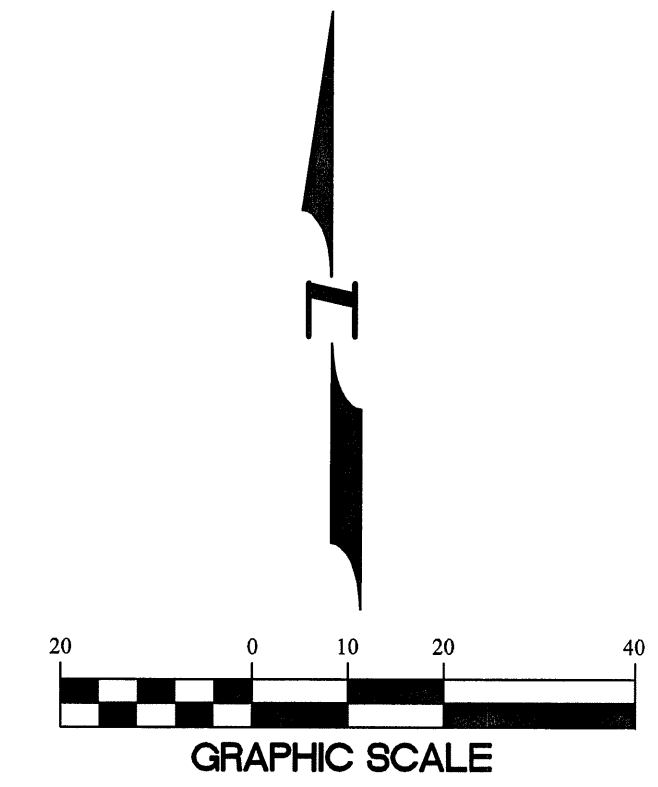

MATCHLINE SEE ABOVE

MATCHLINE SEE BELOW

**LEGEND**

① EDGE LINES (4" WHITE CONTINUOUS)

**NOTES TO CONTRACTOR**

1. CONTRACTOR SHALL NOTIFY TRAFFIC ENGINEERING (206-296-6596) AT LEAST 10 WORKING DAYS PRIOR TO STRIPING TO COORDINATE CHANNELIZATION LAYOUT AND SIGN INSTALLATION.

**GENERAL NOTES**

1. ALL CHANNELIZATION SHALL BE INSTALLED IN ACCORDANCE WITH KING COUNTY ROAD STANDARDS.
2. CONTRACTOR SHALL REMOVE EXISTING STRIPING WHERE IT CONFLICTS WITH PROPOSED CHANNELIZATION.
3. EXISTING STRIPING TO REMAIN SHALL BE REPLACED WHERE DAMAGED OR OBTUSCURED BY CONSTRUCTION ACTIVITIES, OR WHERE FADED, AS DIRECTED BY KING COUNTY.
4. ALL SIGNS SHALL BE INSTALLED BY KING COUNTY DOT.

MAP 317-45(3)

KING COUNTY TRAFFIC ENGINEERING	
ENGINEER	DATE
ENGINEER	DATE
SUPERVISING ENGINEER	DATE

PEPPER HILL ESTATES  
KING COUNTY, WA

FOR:  
PACIFIC HOUSING GROUP I, LLC  
1420 5TH AVE, SUITE 2200  
SEATTLE, WA 98101-3946  
PHONE: (206) 596-9076 FAX: (206) 224-2880  
KING COUNTY ACTIVITY NO. L07SR068, L6CC4101, L06RW031

PROJECT NO.: 05052  
DRAWN BY: ENM  
ISSUE DATE: 11-28-07  
SHEET REV.: 11-20-09

CHANNELIZATION  
PLAN FOR  
MILITARY ROAD  
(NORTH)

05052CH01-RW29.DWG  
**R30A**