

N.W. 1/4, SEC. 26, T. 21 N., R. 4 E., W.M.

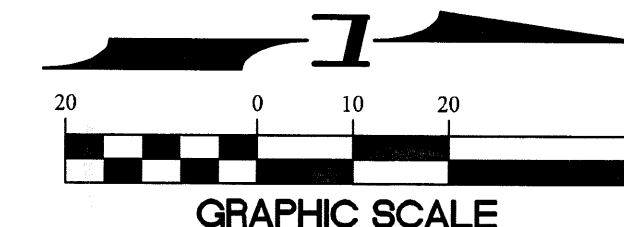

SCALE : 1" = 20'

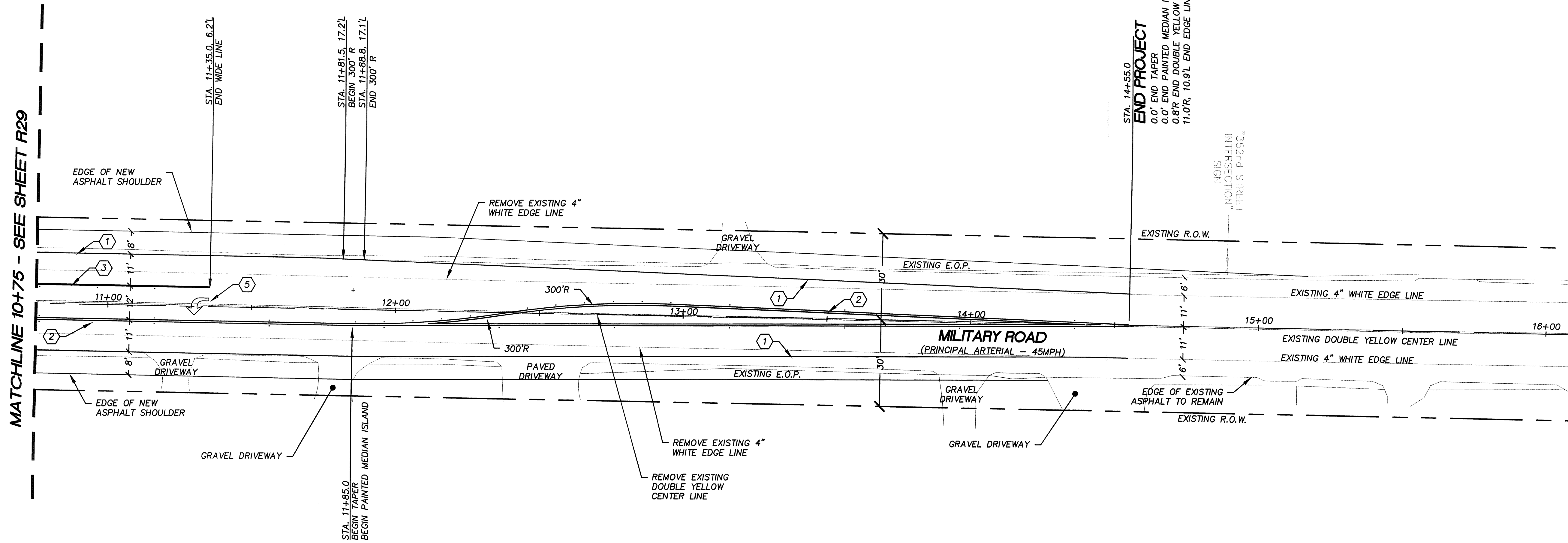

**LEGEND**

- ① EDGE LINES (4" WHITE CONTINUOUS)
- ② CENTERLINE (4"-4"SP-4" DOUBLE YELLOW)
- ③ MOVEMENT SEPARATION (8" PLASTIC WHITE WIDE LINE)
- ④ STOP LINES (16" PLASTIC, EXTENDS TO EDGE OF TRAVELED WAY)
- ⑤ THERMOPLASTIC TURN ARROW

**NOTES TO CONTRACTOR**

1. CONTRACTOR SHALL NOTIFY TRAFFIC ENGINEERING (206-296-6596) AT LEAST 10 WORKING DAYS PRIOR TO STRIPING TO COORDINATE CHANNELIZATION LAYOUT AND SIGN INSTALLATION.

**GENERAL NOTES**

1. ALL CHANNELIZATION SHALL BE INSTALLED IN ACCORDANCE WITH KING COUNTY ROAD STANDARDS.
2. CONTRACTOR SHALL REMOVE EXISTING STRIPING WHERE IT CONFLICTS WITH PROPOSED CHANNELIZATION.
3. EXISTING STRIPING TO REMAIN SHALL BE REPLACED WHERE DAMAGED OR OBSCURED BY CONSTRUCTION ACTIVITIES, OR WHERE FADED, AS DIRECTED BY KING COUNTY.
4. ALL SIGNS SHALL BE INSTALLED BY KING COUNTY DOT.

**MAP 317-45(2)**

**KING COUNTY TRAFFIC ENGINEERING**

ENGINEER	DATE
ENGINEER	DATE
SUPERVISING ENGINEER	DATE



15445 53RD AVE. S.  
SEATTLE, WA 98188  
PHONE: (206) 431-7970  
FAX: (206) 388-1648  
WEB SITE: PACENG.COM

**Pacific Engineering Design, LLC**  
Civil Engineering and Planning Consultants

**PEPPER HILL ESTATES**  
KING COUNTY, WA.  
FOR: PACIFIC HOUSING GROUP I, LLC  
1420 5TH AVE. SUITE 2200  
SEATTLE, WA 98101  
PHONE: (206) 521-5976 FAX: (206) 224-2880  
KING COUNTY ACTIVITY NO. L07SR068, L6CG4101, L06RW031

PROJECT NO.: **05052**  
DRAWN BY: **ENM**  
ISSUE DATE: **11-28-07**  
SHEET REV.: **11-20-09**

**CHANNELIZATION PLAN FOR MILITARY ROAD (NORTH)**

05052CH01-RW29.DWG  
**R30**