

N.W. 1/4, SEC. 26, T. 21 N., R. 4 E., W.M.

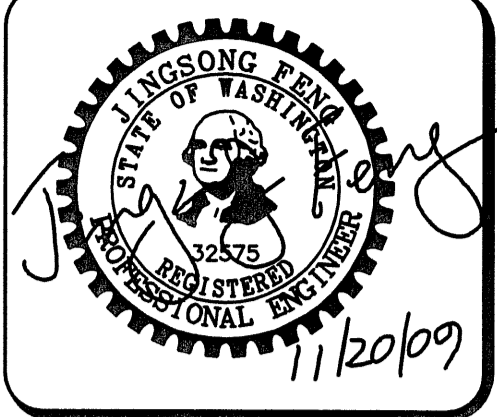

15445 53RD AVE. S.
SEATTLE, WA 98188
PHONE: (206) 431-7970
FAX: (206) 388-1648
WEB SITE: PACENG.COM

Pacific
Engineering
Design, LLC

Civil Engineering and
Planning Consultants

PEPPER HILL ESTATES
KING COUNTY, WA.

FOR:
PACIFIC HOUSING GROUP I, LLC
1420 5TH AVE. SUITE 2200
SEATTLE, WA 98101
PHONE: (206) 521-5973 FAX: (206) 224-2880
KING COUNTY ACTIVITY NO. L07SR068, L6CG4101, L06RW031

PROJECT NO.: 05052
DRAWN BY: ENM
ISSUE DATE: 11-28-07
SHEET REV.: 11-20-09

CHANNELIZATION
PLAN FOR
MILITARY ROAD
(SOUTH)

05052CH01-RW29.DWG
R29

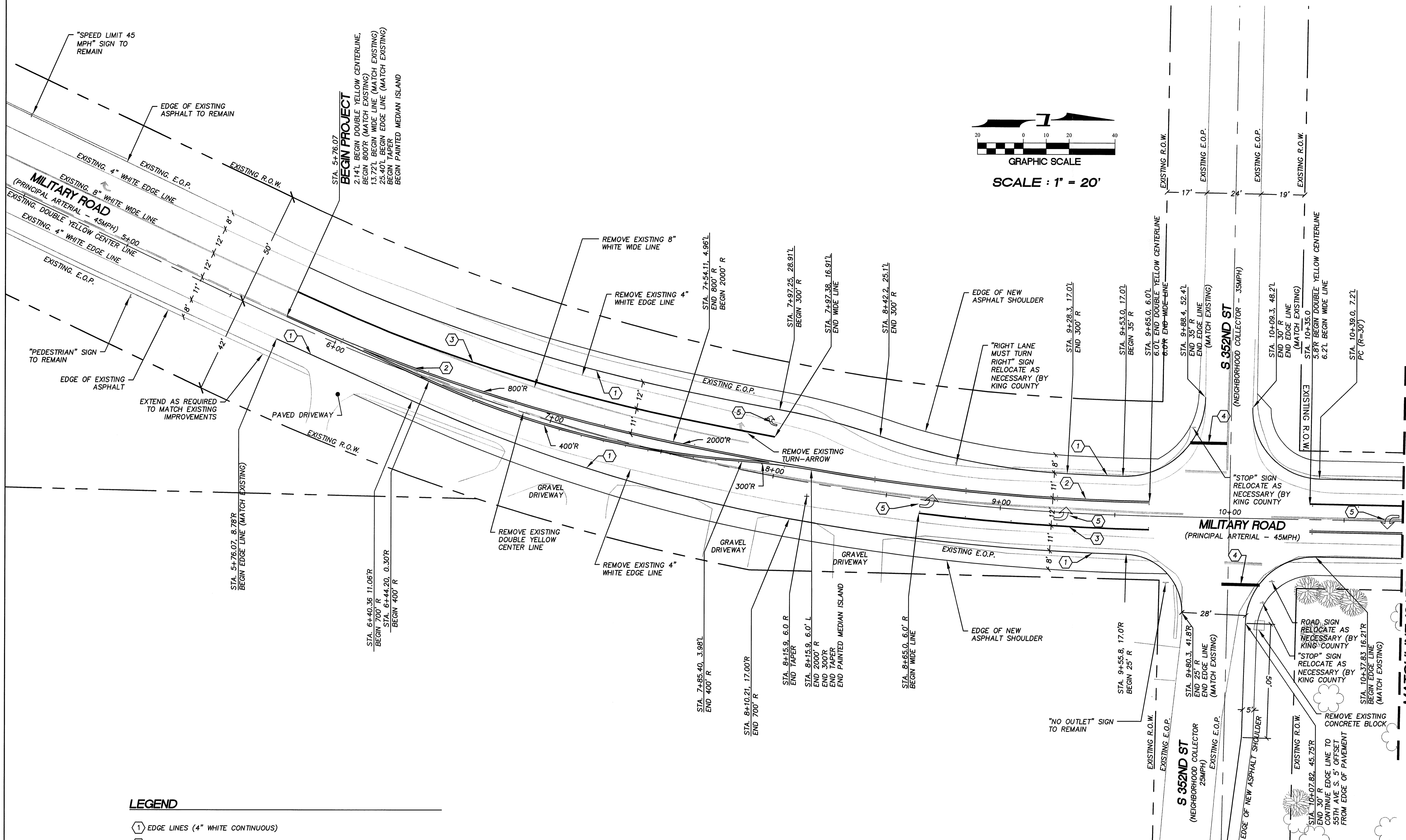
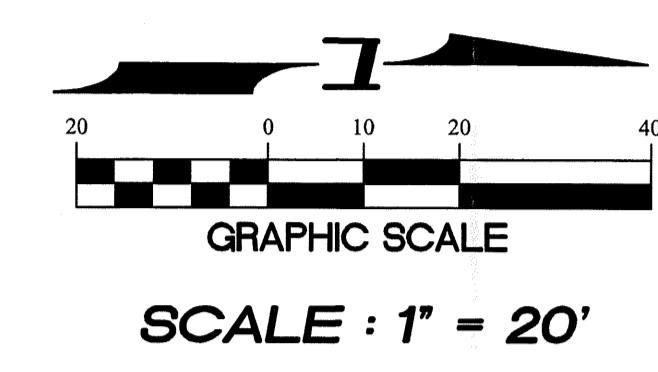

- LEGEND**
- ① EDGE LINES (4" WHITE CONTINUOUS)
 - ② CENTERLINE (4"-4"SP-4" DOUBLE YELLOW)
 - ③ MOVEMENT SEPARATION (8" PLASTIC WHITE WIDE LINE)
 - ④ STOP LINES (16" PLASTIC, EXTENDS TO EDGE OF TRAVELED WAY)
 - ⑤ THERMOPLASTIC TURN ARROW

NOTES TO CONTRACTOR

- CONTRACTOR SHALL NOTIFY TRAFFIC ENGINEERING (206-296-6596) AT LEAST 10 WORKING DAYS PRIOR TO STRIPING TO COORDINATE CHANNELIZATION LAYOUT AND SIGN INSTALLATION.

- GENERAL NOTES**
- ALL CHANNELIZATION SHALL BE INSTALLED IN ACCORDANCE WITH KING COUNTY ROAD STANDARDS.
 - CONTRACTOR SHALL REMOVE EXISTING STRIPING WHERE IT CONFLICTS WITH PROPOSED CHANNELIZATION.
 - EXISTING STRIPING TO REMAIN SHALL BE REPLACED WHERE DAMAGED OR OBTUSCURED BY CONSTRUCTION ACTIVITIES, OR WHERE FADED, AS DIRECTED BY KING COUNTY.
 - ALL SIGNS SHALL BE INSTALLED BY KING COUNTY DOT.

MAP 317-45(1)

KING COUNTY TRAFFIC ENGINEERING

ENGINEER	DATE
ENGINEER	DATE
SUPERVISING ENGINEER	DATE

MATCHLINE 10+75 - SEE SHEET R30