

N.W. 1/4, SEC. 26, T. 21 N., R. 4 E., W.M.

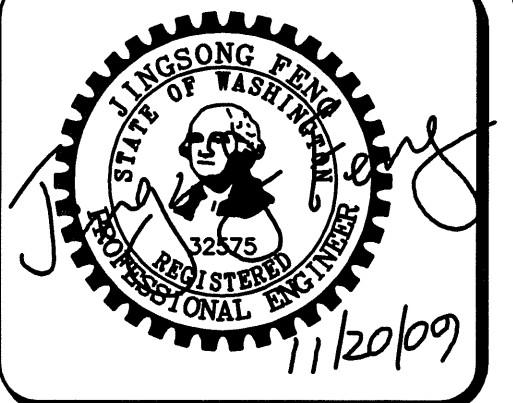
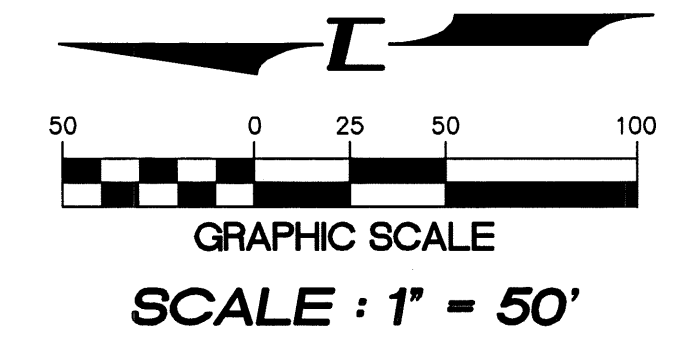

15445 53RD AVE. S.  
SEATTLE, WA 98188  
PHONE: (206) 431-7970  
FAX: (206) 388-1648  
WEB SITE:  
PACENG.COM

**Pacific  
Engineering  
Design, LLC**

Civil Engineering and  
Planning Consultants

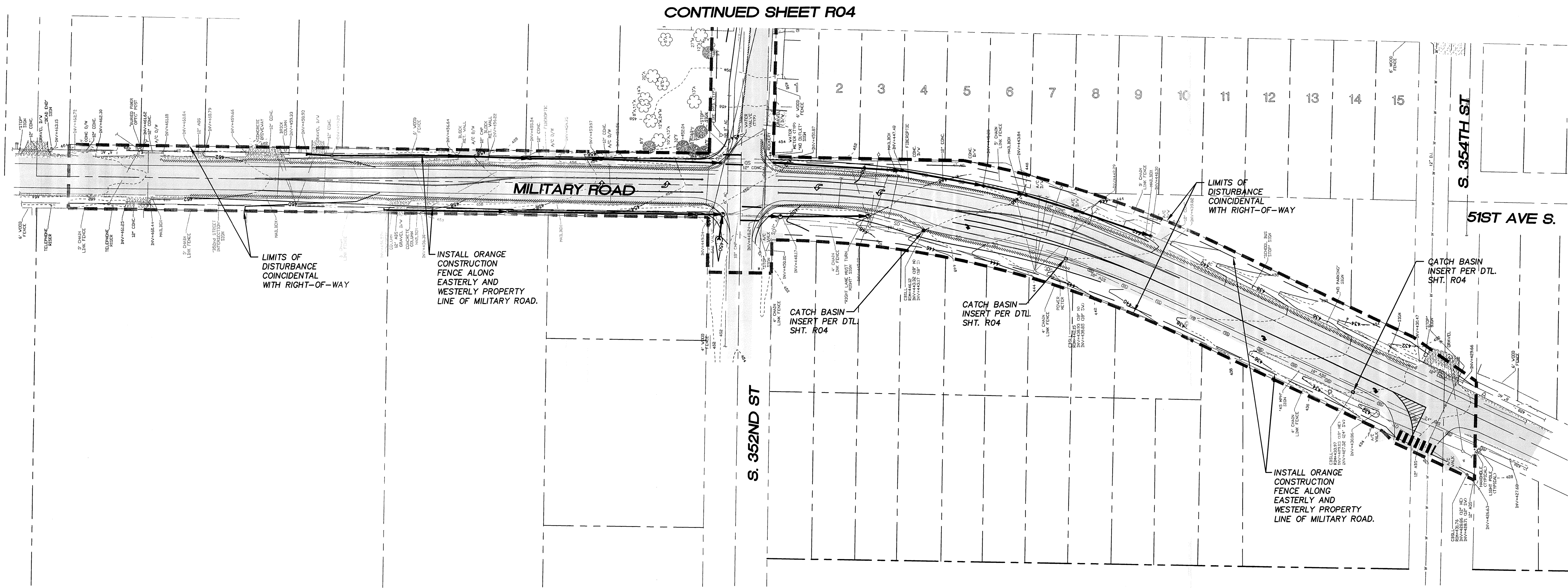

LIMITS OF  
DISTURBANCE  
COINCIDENTAL  
WITH RIGHT-OF-WAY

INSTALL ORANGE  
CONSTRUCTION  
FENCE ALONG  
EASTERLY AND  
WESTERLY PROPERTY  
LINE OF MILITARY ROAD.

CATCH BASIN  
INSERT PER DTL  
SHT. R04

CATCH BASIN  
INSERT PER DTL  
SHT. R04

LIMITS OF  
DISTURBANCE  
COINCIDENTAL  
WITH RIGHT-OF-WAY

INSTALL ORANGE  
CONSTRUCTION  
FENCE ALONG  
EASTERLY AND  
WESTERLY PROPERTY  
LINE OF MILITARY ROAD.

CATCH BASIN  
INSERT PER DTL  
SHT. R04

**PEPPER HILL ESTATES**  
KING COUNTY, WA

FOR:  
PACIFIC HOUSING GROUP I, LLC  
1420 5TH AVE, SUITE 2200  
SEATTLE, WA 98101-3246  
PHONE: (206) 521-9979 | FAX: (206) 224-2880

PROJECT NO.: **05052**  
DRAWN BY: **JGC**  
ISSUE DATE: **08-04-08**  
SHEET REV.: **11-20-09**

**TEMPORARY  
EROSION/  
SEDIMENTATION  
CONTROL PLAN  
(MILITARY ROAD)**

KING COUNTY D.D.E.S.	
Review Engineer	Completion Date
Senior Engineer	Completion Date
MOLLY A. JOHNSON, P.E. DEVELOPMENT ENGINEER	Approval Date
Comments:	

05052TE02-RW04A.DWG  
**R04A**