

PEPPER HILL ESTATES

KING COUNTY, WA

LAKEHAVEN UTILITY DISTRICT
 0 Water Plan
 Dated **8/24/10** Sewer Plan
 APPROVED FOR CONSTRUCTION
 SUBJECT TO CHANGES NOTED
 General Manager/District Engineer *[Signature]* Date **9/23/10**
 This construction plan will expire one year from plan approval date, if construction has not commenced.



15445 53RD AVE S.
 SEATTLE, WA 98188
 PHONE: (206) 431-7970
 FAX: (206) 388-1648
 WEB SITE: PACENG.COM

Pacific Engineering Design, LLC
 Civil Engineering and Planning Consultants

NOTE:
 THIS PROJECT SHALL BE CONSTRUCTED IN ACCORDANCE WITH LAKEHAVEN UTILITY DISTRICT WATER SYSTEM AND SEWER SYSTEM STANDARDS AND ANY ADDENDA THERETO.

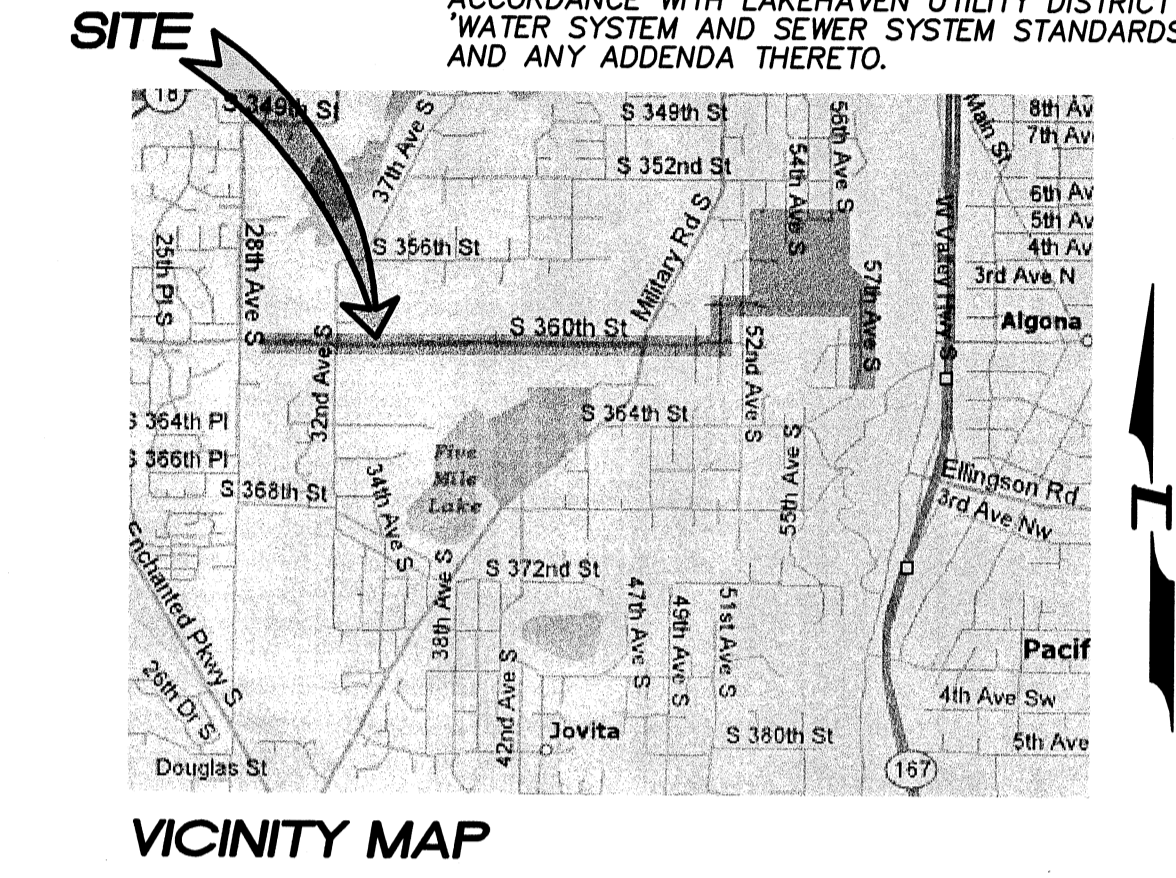

LEGEND

EXISTING	PROPOSED	
—S— SANITARY SEWER MAIN	— SANITARY SEWER FORCE MAIN	— WATER MAIN
⊙ SEWER MANHOLE	⊗ ISOLATION GATE VALVE W/BOX	⊗ WATER VALVE
—SD— STORM LINE	⊗⊗ FORCE MAIN CLEANOUT W/PIG PORT (INLINE)	⊗ WATER METER
—W— WATER MAIN	⊗ WYE	⊗ TEE W/CONCRETE THRUST BLOCK
⊗ WATER METER	⊗⊗ FORCE MAIN CLEANOUT W/PIG PORT (END OF PIPE RUN)	⊗ ELBOW W/CONCRETE THRUST BLOCK
⊗ WATER VALVE	⊗ ELBOW	⊗ CAP W/CONCRETE THRUST BLOCK
⊗ FIRE HYDRANT	⊗ REDUCER	⊗ FIRE HYDRANT
PP⊙ POWER POLE	⊗ SPOOL	⊗ REDUCER
LP⊗ LIGHT POLE	⊗ SIDE SERVICE	— STORM LINE
—OHP— OVER HEAD POWER LINE	⊗ ELBOW W/WATERTIGHT BOLTED BLIND FLANGE FOR FUTURE EXPANSION	▨ TYPE I CB
—GAS— GAS MAIN		▨ TYPE II CB
▨ TYPE I CB		▨ ROOF DRAIN MAINFOLD
▨ TYPE II CB		▨ ASPHALT PAVEMENT
▨ ASPHALT PAVING		▨ CONCRETE SIDEWALK
—422— CONTOUR		▨ CONCRETE CURB AND GUTTER
—W— WATER MAIN ASSUMED LOCATION		—422— CONTOUR
—G— GAS MAIN ASSUMED LOCATION		

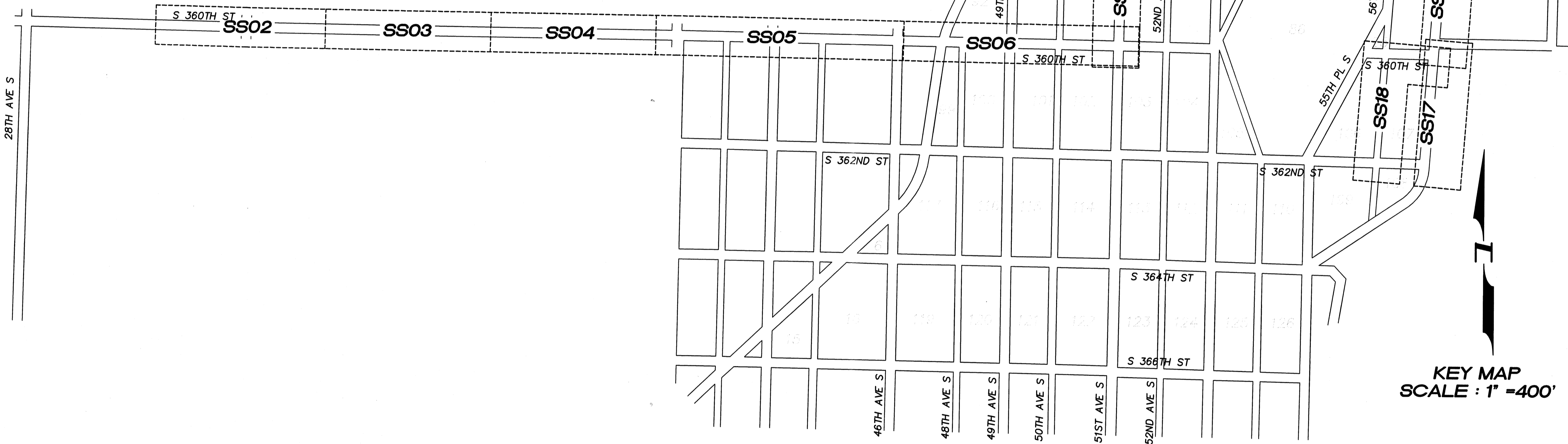

KEY MAP
 SCALE: 1" = 400'

HORIZONTAL CONTROL
 1. KING COUNTY SURVEY CONTROL POINT No. 6897, EAST QUARTER OF SECTION 28, T 21 N, R 4 E, W.M., CONCRETE MONUMENT WITH LEAD AND BRASS TACK, SET 1.6 FEET BELOW GRADE, IN STANDARD KC MON. CASE. NORTHING: 105165.739 (FEET) EASTING: 1278265.994 (FEET)
 2. KING COUNTY SURVEY CONTROL POINT No. 6907, NE CORNER OF SECTION 33, T 21 N, R 4 E, W.M., CONCRETE MONUMENT WITH LEAD AND BRASS TACK, SET 0.6 FEET BELOW GRADE, IN STANDARD KC MON. CASE. NORTHING: 102529.986 (FEET) EASTING: 1278209.517 (FEET)

VERTICAL DATUM:
 NAVD 88
BENCH MARK:
 KING COUNTY SURVEY CONTROL POINT No. 6905, SW CORNER OF SECTION 27, T 24 N, R 4 E, W.M., CONCRETE MONUMENT WITH LEAD AND BRASS TACK, SET 1.2 FEET BELOW GRADE, IN STANDARD KC MON. CASE. ELEVATION = 367.06
 TO CONVERT FROM NAVD 88 TO NGVD-29 USE -3.58'
 EXAMPLE: 367.06 NAVD 88
 -3.58
 363.48 NGVD-29
 THE DATUM WILL BE CONVERTED TO KCAS (NGVD-29) DURING 'AS-BUILDING' STAGE.

SHEET INDEX

SS01	FORCE MAIN SANITARY SEWER COVER SHEET
SS02	FORCE MAIN SANITARY SEWER S 360TH ST STA. 171+00.70 TO STA. 181+07.00 PLAN AND PROFILE
SS03	FORCE MAIN SANITARY SEWER S 360TH ST STA. 181+07.00 TO STA. 191+07.00 PLAN AND PROFILE
SS04	FORCE MAIN SANITARY SEWER S 360TH ST STA. 191+07.00 TO STA. 201+07.00 PLAN AND PROFILE
SS05	FORCE MAIN SANITARY SEWER S 360TH ST STA. 201+07.00 TO STA. 215+47.15 PLAN AND PROFILE
SS06	FORCE MAIN SANITARY SEWER S 360TH ST STA. 215+47.15 TO STA. 228+90.70 PLAN AND PROFILE
SS07	FORCE MAIN SANITARY SEWER S 360TH ST/51ST AVE S STA. 228+90.70 TO STA. 238+50.33 PLAN AND PROFILE
SS08	FORCE MAIN SANITARY SEWER S 358TH ST/53RD AVE S/S 356TH ST STA. 238+50.33 TO STA. 248+37.28 PLAN AND PROFILE
SS09	FORCE MAIN SANITARY SEWER S 356TH ST STA. 248+37.28 TO STA. 251+77.45=110+00.00 TO STA. 112+73.36 PLAN AND PROFILE
SS10	FORCE MAIN SANITARY SEWER 53RD AVE S PLAN AND PROFILE
SS11	FORCE MAIN SANITARY SEWER 54TH AVE S PLAN AND PROFILE
SS12	FORCE MAIN SANITARY SEWER S 354TH ST STA. 112+73.36 TO STA. 123+00.00 PLAN AND PROFILE
SS13	FORCE MAIN SANITARY SEWER 55TH AVE S PLAN AND PROFILE
SS14	FORCE MAIN SANITARY SEWER 56TH AVE S AND S 356TH ST STA. 22+35.37 TO STA. 30+00.00 PLAN AND PROFILE
SS15	FORCE MAIN SANITARY SEWER S 356TH ST AND 57TH AVE S STA. 14+29.00 TO STA. 22+35.37 PLAN AND PROFILE
SS16	FORCE MAIN SANITARY SEWER 57TH AVE S STA. 7+38.92 TO STA. 14+29.00 PLAN AND PROFILE
SS17	FORCE MAIN SANITARY SEWER 57TH AVE S STA. 0+71.08 TO STA. 7+38.92 PLAN AND PROFILE
SS18	FORCE MAIN SANITARY SEWER 56TH AVE S/S 360TH ST PLAN AND PROFILE
SS19	FORCE MAIN SANITARY SEWER 56TH AVE S PLAN AND PROFILE
SS20	FORCE MAIN SANITARY SEWER DETAILS
SS21	FORCE MAIN SANITARY SEWER CROSS SECTIONS
SS22	FORCE MAIN SANITARY SEWER PUMP STATION DETAILS
SS23	FORCE MAIN SANITARY SEWER PUMP STATION DETAILS

OWNERS
 PACIFIC HOUSING GROUP I, LLC
 1420 5TH AVE, SUITE 2200
 SEATTLE, WA, 98101-1346
 PHONE: (206) 521-5979
 FAX: (206) 224-2880

PROJECT ENGINEER/PLANNER
 PACIFIC ENGINEERING DESIGN, LLC
 15445 53RD AVE. S.
 SEATTLE, WA, 98188
 PHONE: (206) 431-7970
 FAX: (206) 388-1648

WASTEWATER ENGINEER
 CORRECT EQUIPMENT, INC.
 14576 NE 95TH ST.
 REDMOND, WA, 98052
 PHONE: (425) 869-1233
 FAX: (425) 869-1033

UTILITY PURVEYORS
 WATER: LAKEHAVEN UTILITY DISTRICT
 SEWER: LAKEHAVEN UTILITY DISTRICT
 POWER: PUGET SOUND ENERGY
 TELEPHONE: QWEST COMMUNICATIONS
 CABLEVISION: ATT BROADBAND
 GAS: PUGET SOUND ENERGY
 SCHOOL DISTRICT: FEDERAL WAY SCHOOL DISTRICT
 FIRE DISTRICT: FIRE DISTRICT

APPLICANT
 PACIFIC HOUSING GROUP I, LLC
 1420 5TH AVE, SUITE 2200
 SEATTLE, WA, 98101-1346
 PHONE: (206) 521-5979
 FAX: (206) 224-2880

SURVEYOR
 HANSEN SURVEYING
 17420 116TH AVE S.E.
 RENTON, WA, 98058
 PHONE: (425) 253-8440
 FAX: (425) 253-0266

SURVEYOR
 C.E.S. NW INC.
 5210 12TH AT. E.,
 SUITE 200
 FIFE, WA, 98424
 PHONE: (253) 922-1532
 FAX: (253) 922-1954

LAKEHAVEN UTILITY DISTRICT PROJECT No. 6304025
 PEPPER HILL ESTATES
 KING COUNTY, WA.
 FOR: PACIFIC HOUSING GROUP I, LLC
 1420 5TH AVE, SUITE 2200
 SEATTLE, WA, 98101-1346
 PHONE: (206) 521-5979 FAX: (206) 224-2880

PROJECT NO.: **05052**
 DRAWN BY: **JGC**
 ISSUE DATE: **09-30-05**
 SHEET REV.: **08-24-10**

FORCE MAIN SANITARY SEWER COVER SHEET

05052SS01.DWG
SS01